

# REIST INDUSTRIES

**INNOVATION WORKING FOR YOU**

100 Union Street • Elmira, Ontario, Canada • N3B 2Z2

Toll Free: 877-467-3478 • Tel.: 519-669-1501

[www.reistindustries.com](http://www.reistindustries.com)

## Operator's Manual

Keep this manual with the machine at all times

### R25PSS - R25PSV

Stump Grinder 3PH PTO Driven Hydraulic Swing

**DOMINATOR**

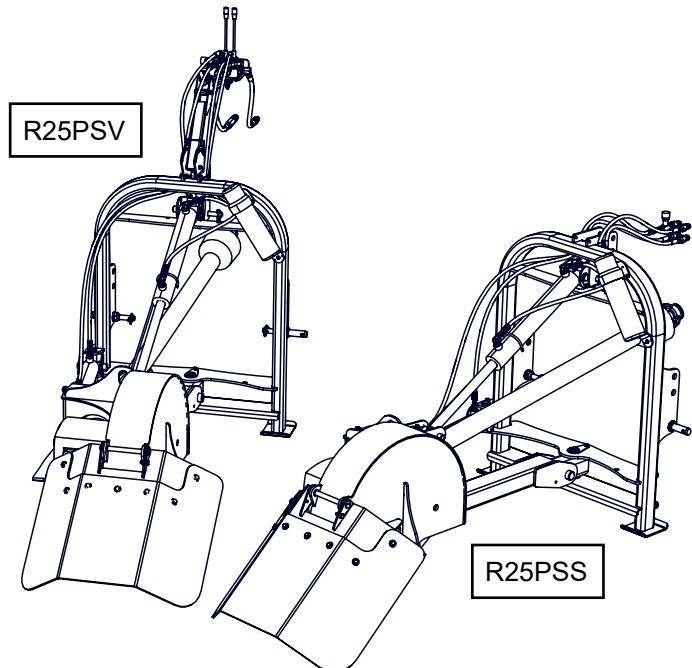

**CAUTION**  
**Operational Hazard**  
Grind safe - avoid underground utilities! Always contact your local utility companies (electrical, telephone, gas, water, sewer, and others) before starting

**CAUTION**  
**Operational Hazard**  
Personal Protection Equipment (PPE) is required when operating or maintaining this machine.



Do not attempt to operate the equipment without thoroughly reviewing this manual for safe and proper operation.

# Notes

# TABLE OF CONTENTS

<b>Introduction</b> . . . . .	<b>4</b>	<b>Field Operation</b> . . . . .	<b>22</b>
OPERATOR ORIENTATION . . . . .	4	Operation Safety Checklist . . . . .	22
<b>General Information</b> . . . . .	<b>5</b>	Prepare . . . . .	22
Intended Use . . . . .	5	Mount the Stump Grinder . . . . .	23
California Proposition 65 . . . . .	5	Operating the Stump Grinder . . . . .	24
<b>Serial Number Location</b> . . . . .	<b>5</b>	Start the Grinding Process . . . . .	24
<b>Safety</b> . . . . .	<b>6</b>	If there is remaining stump: . . . . .	25
Safety Messages . . . . .	6	R25PS Series User Tips . . . . .	26
Accident Prevention . . . . .	7	<b>Storage</b> . . . . .	<b>27</b>
Safety Guidelines . . . . .	8	Storage Safety Checklist . . . . .	27
Safety Training . . . . .	8	Prepare for Storage: . . . . .	27
Preparation . . . . .	9	Placing in Storage: . . . . .	27
Wood Dust Hazard . . . . .	9	<b>Service &amp; Maintenance</b> . . . . .	<b>28</b>
Storage Safety . . . . .	9	Maintenance Safety Checklist . . . . .	28
Operation Safety . . . . .	9	General Maintenance . . . . .	28
Maintenance Safety . . . . .	10	Gearbox Maintenance . . . . .	28
Safe Work Area . . . . .	10	Lubrication . . . . .	29
Transport Safety . . . . .	10	Cutting wheel . . . . .	30
PTO Drive-line Safety . . . . .	11	Inspect Cutting Teeth . . . . .	30
<b>Safety Labels</b> . . . . .	<b>12</b>	Indexing Cutting Teeth . . . . .	30
Safety Label Descriptions . . . . .	12	Replacing Cutting Teeth . . . . .	31
If labels need to be replaced: . . . . .	12	Replacing Tooth Pockets . . . . .	31
Safety Label Layout . . . . .	13	Drive-line . . . . .	32
<b>Specifications and Dimensions</b> . . . . .	<b>14</b>	PTO Drive-line Clutch . . . . .	32
Specifications . . . . .	14	PTO Drive-line Clutch Spring Height . . . . .	33
Dimensions . . . . .	14	Lubrication . . . . .	33
<b>Inspection</b> . . . . .	<b>14</b>	Bolt Torque Table . . . . .	34
<b>Components and Features</b> . . . . .	<b>15</b>	<b>Trouble Shooting</b> . . . . .	<b>35</b>
Rotor View . . . . .	15	<b>Accessories</b> . . . . .	<b>38</b>
Frame View . . . . .	16	# STGV R25PS Valve Kit . . . . .	38
<b>Initial Setup</b> . . . . .	<b>17</b>	# DS510 Debris Screen . . . . .	38
HDPE Deflector Install . . . . .	17	<b>WARRANTY</b> . . . . .	<b>39</b>
Prepare the Quick Hitch . . . . .	17		
Check Gearbox Oil Level . . . . .	17		
Sizing PTO Drive-line . . . . .	18		
Prepare the Drive-Line . . . . .	19		
PTO Drive-line Clutch Preparation . . . . .	19		
PTO & Hydraulic Test Installation: . . . . .	20		
Adjustable Arm - R25PSV . . . . .	21		
Arm Positioning . . . . .	21		

## INTRODUCTION

Congratulations on your choice of a Reist Industries **R25PSS or R25PSV 3PH PTO Hydraulic Swing Stump Grinder** to complement your stump grinding operation. This equipment has been designed and manufactured to meet the needs of a discriminating buyer for efficient grinding of stumps.

Both Models features 18 rotatable carbide cutting teeth, resulting in longer tooth life and smoother cutting for less wear on the tractor. The 25 in. cutting wheel spins at 1026 rpm, combined with carbide teeth means finer mulch and smoother operation.

Tractor hydraulics power the **R25PSS / R25PSV** grinder head's 55°arc swing and can raise up to 20" from ground level.

The cutting wheel is powered by the 540 RPM (max) PTO on your tractor supported by a CAT I or CAT II three point hitch. Grease zerks are provided at major pivot points for extended service life. The HDPE (high density polyethylene ) debris shield is standard equipment on all Reist stump grinders. It is recommended that the stump grinder never be operated without the debris shield in place.

Safe, efficient and trouble free operation of your stump grinder requires that you and anyone else who will be operating or maintaining the stump grinder, read and understand the Safety, Operation, Maintenance and Troubleshooting information contained within the Operator's Manual.

Use the Table of Contents as a guide to locate required information. Keep this manual handy for frequent reference and to pass on to new operators or owners. Call your Reist dealer, distributor or the factory if you need assistance, information or additional copies of the manuals.

When this machine is worn out and no longer in use, it should be returned to the retailer or other party for recycling.

This manual covers models: **R25PSS & R25PSV 3PH PTO Hydraulic Swing Stump Grinder.**

### OPERATOR ORIENTATION

The directions left, right, front and rear, as mentioned throughout this manual, are as seen from the tractor driver's seat and facing in the direction of travel, unless noted otherwise.

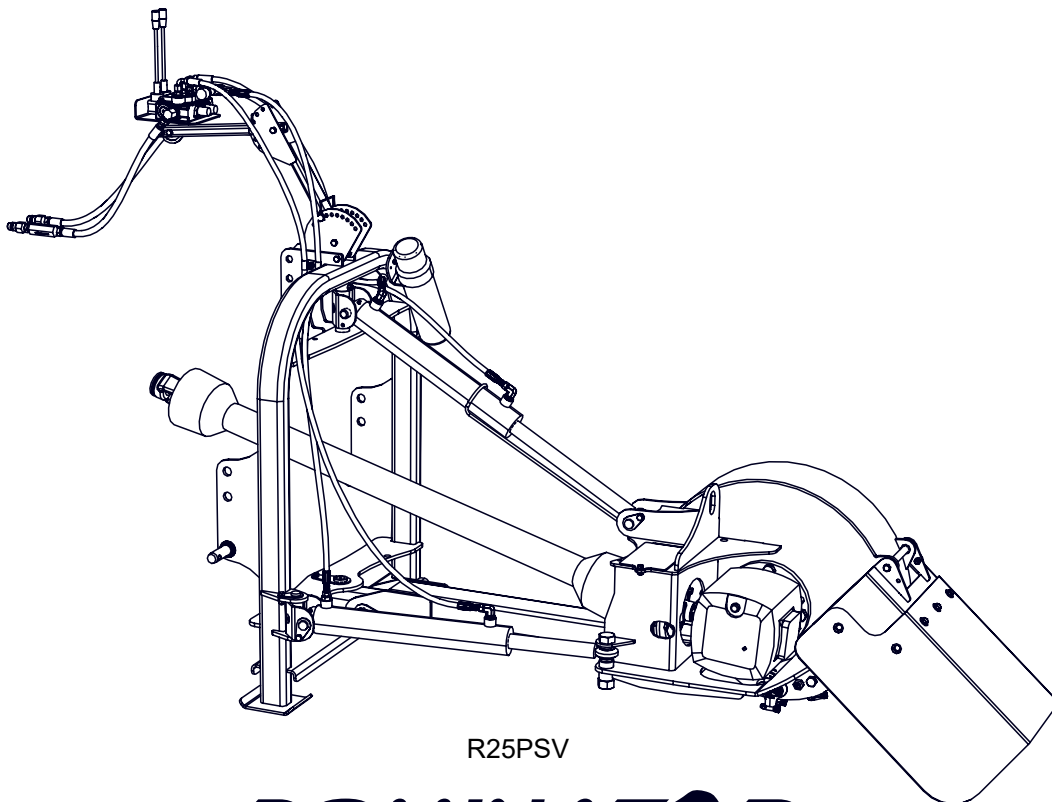

R25PSV

**DOMINATOR**

## GENERAL INFORMATION

The purpose of this manual is to assist you in safely operating and maintaining your **R25PS Series Stump Grinder** in a safe manner. Read this manual carefully to obtain valuable information and instructions that will help you achieve safe and dependable service.

The stump grinding tool is designed to be used by experienced operators, trained in the safe operation of a tractor and trained in the hazards related to using the stump grinder and the safe use of the grinder for the intended purpose. Operators will require personal protective equipment to reduce the risk from some hazards that cannot be completely eliminated or controlled by the design of the tool.

The **R25PS Series** is intended to be used within the specifications shown in this manual. Care is required to ensure that the stump grinding rotor will not come in contact with metallic objects, stones or other hard or immovable materials while grinding.

The **R25PS Series** is not designed for use in hazardous atmospheres where there is a risk of fire or explosion due to flammable gases or vapors. Use in hazardous, explosive atmospheres is prohibited. Serious injury or death of the operator or bystanders may be caused if the tool is misused. Misuse may also cause damage to the tractor carrying the implement.

The illustrations and data used in this manual were current at the time of printing, but due to possible engineering and or production changes, this product may vary slightly in detail. Reist Industries reserves the right to update and or change components as necessary without notification.

In this manual the **R25PS Series** may be referred to as grinder, stump grinder, machine, implement or attachment.

Tractor refers to any power unit attached to a **R25PS Series** stump grinder.

### INTENDED USE

The **R25PSS or R25PSV 3PH PTO Hydraulic Swing Stump Grinder** is intended for rear mount three point hitch attachment and use on qualified power units for the sole purpose of grinding tree stumps within the specifications listed in this manual.

### CALIFORNIA PROPOSITION 65

You may see a warning label like the following:

This warning is required by California Proposition 65 (Prop 65), which is meant to notify California residents of exposures to Prop 65-listed chemicals. For more information go to [www.P65Warnings.ca.gov](http://www.P65Warnings.ca.gov).



## SERIAL NUMBER LOCATION

The serial number for your **R25PS Series** is located side of the PTO guard.

Please record your serial number here as a handy reference. In case of warranty issues, your dealer will ask for the serial number to verify your warranty.

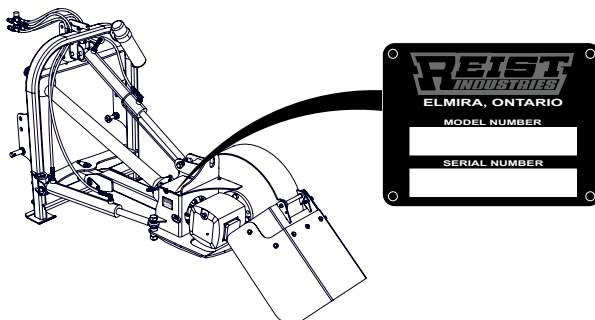

Model Number \_\_\_\_\_

Serial Number \_\_\_\_\_

# SAFETY



This Safety Alert Symbol means:  
**ATTENTION!**  
**BECOME ALERT!**  
**YOUR SAFETY IS INVOLVED!**

The Safety Alert symbol identifies important safety messages on the implement and in the manual. When you see this symbol, read and understand the message, be alert to the potential hazard in the message. Follow the instructions in the safety message.

## SAFETY MESSAGES

Throughout this manual, the terms **DANGER**, **WARNING**, **CAUTION** and **IMPORTANT** are used to indicate the degree of hazard to personnel if proper safety procedures and guidelines are not followed. The appropriate term for each message has been selected using the following guide-lines:

**DANGER** - Indicates an imminently hazardous situation that, if not avoided, will result in death or serious injury, and includes most extreme situations typically for implement components which, for functional purposes, cannot be guarded.

**WARNING** - Indicates a potentially hazardous situation that, if not avoided, could result in death or serious injury, and includes hazards that are exposed when guards are removed. It may also be used to alert against unsafe practices.

**CAUTION** - Indicates a potentially hazardous situation that, if not avoided, may result in minor or moderate injury. It may also be used to alert against unsafe practices.

**IMPORTANT** - Indicates a situation that could result in damage to the implement or other property.

In the owners manual, when a hazard is present you will see a safety message box. The box may contain:

- The safety alert symbol,
- The safety term
- The safety hazard
- The safety hazard explanation

When applicable you may also see the appropriate safety label displayed with the message, as shown below.

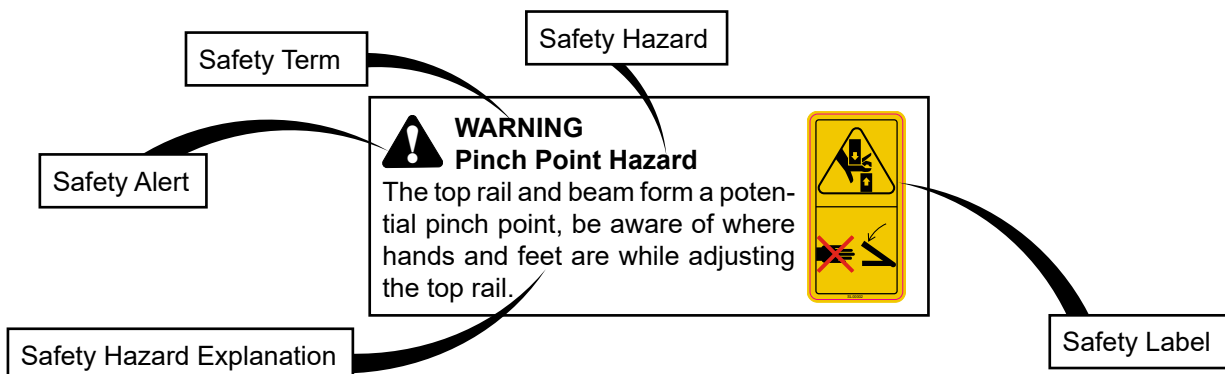

The safety information given in this manual does not replace any safety codes, insurance needs, government and local laws.

## ACCIDENT PREVENTION

# ACCIDENTS CAN BE PREVENTED WITH YOUR HELP!

**YOU** are responsible for the SAFE operation and maintenance of your implement. **YOU** must ensure that you and anyone else who is going to use, maintain or work around the implement be familiar with the work and maintenance procedures and related SAFETY information contained in this manual. This manual will take you step-by-step through your working day and alerts you to all good safety practices that should be used.

Remember, **YOU** are the key to safety. Good safety practices not only protect you but also the people around you. Make these practices an effective part of your day to day work habits. Be certain that EVERYONE using this implement is familiar with the recommended maintenance and work procedures and follow all the safety precautions. Most accidents can be prevented. Do not risk injury or death by ignoring good safety practices.



**The best accident prevention is a careful operator.**

**Reist Industries and your dealer ask that YOU be that careful, responsible equipment operator.**

### **YOU ARE THE KEY TO SAFETY:**



•Familiarize yourself, and anyone else who will operate, maintain, or work around this product, with the safety and operation information contained in this manual.

- Read and understand the safety labeling which appears on the implement.
- Have a first-aid kit available for use should the need arise and know how to use it. 
- Pay attention to the job at hand. Do not let your mind lose concentration on what you are doing. No accident prevention program can be successful without the wholehearted cooperation of the person who is directly responsible for the operation of the implement.
- Have a fire extinguisher available for use should the need arise and know how to use it. 
- Reduce the risk of injury or death by following all safety precautions and by using good safety practices.
- Accidents can to be prevented: that prevention will come from equipment operators who accept their complete responsibility and anticipate the results of their actions.

- Never exceed the limits of the implement. Safety of the operator and safe operation are the main concerns in designing a safe product, however ignoring implement specifications by the operator can result in a accident which could have been prevented.



- Do not allow riders on the implement, loaded or empty.
- Do not operate this implement under the influence of drugs or alcohol.
- Be responsible for the SAFE operation and MAINTENANCE of YOUR implement.
- Wear appropriate personal protective equipment (PPE). This list includes but is not limited to:

- Hard hat
- Heavy gloves
- Hearing Protection
- Protective foot wear
- Protective eye wear
- Safety Vest
- Dust Mask



## SAFETY GUIDELINES

Safety of the operator and bystanders is one of the chief concerns in developing and designing equipment. However, every year many accidents occur which could have been avoided by a few seconds of thought and a more cautious approach to handling equipment.

You, the operator, can avoid many accidents by observing the following precautions in this section. To avoid personal injury or death, study the following precautions and insist those working with you, or for you to follow them.

In addition to the design and configuration of this implement, including safety labels and safety devices, hazard control and accident prevention are dependent upon the awareness, concern, and proper training of personnel involved in the operation, transport, maintenance, and storage of the implement. Refer also to safety messages and operation instruction in each of the appropriate sections of the tractor and implement manuals. Pay close attention to the safety labeling affixed to the implement.

1. In order to provide a better view, certain illustrations in this manual may show an assembly with a safety device removed. However, equipment should never be used in this condition. Keep all safety devices in place, if removal becomes necessary for repairs, replace the device prior to use.
2. Replace any safety label or instruction sign that is unreadable or is missing. Location of safety signs is indicated in this manual.
3. Never use alcoholic beverages or drugs which can hinder alertness or coordination while using this implement. Consult your doctor about using this implement while taking prescription medications.
4. Under no circumstances should young children be allowed to work with this implement.
5. This implement is dangerous to persons unfamiliar with its operation. Do not allow persons to use or assemble this unit until they have read this manual and have developed a thorough understanding of the safety precautions and of how it works. Review the safety instructions with all users annually.
6. If the elderly are assisting with work, their physical limitations need to be recognized and accommodated. Assistants should be a responsible, properly trained and physically able person familiar with machinery and trained in this implement's operations.
7. Never exceed the limits of the implement. If its ability to do a job, or to do so safely, is in question - DON'T TRY IT.
8. Do not modify the implement in any way. Unauthorized modification may result in serious injury or death and may impair the function and life of the implement.

## SAFETY TRAINING

A person who has not been trained or has not read and understood all use and safety instructions is not qualified to use the implement. An untrained operator exposes himself and bystanders to possible serious injury or death.

- Train all new personnel with the instructions alongside the implement. Be certain only a properly trained and physically able person will use the machinery.
- Working with unfamiliar equipment can lead to careless injuries. If this implement is used by any person other than yourself, or is loaned or rented, it is the implement owner's responsibility to make certain that the operator, prior to using:
  - Reads and understands the operator's manuals.
  - Is instructed in safe and proper use of the implement
  - If the elderly are assisting with the work, their physical limitations need to be recognized and accommodated.
- Operators or maintenance personnel who are not fully able to read and understand this manual should not operate or work on the implement:
- Make certain that all operators and maintenance personnel have complete understanding of the full and exact contents of this manual and safety labeling.
- ALL information contained in this manual and labeling on the implement must be conveyed CLEARLY and FULLY, in order to be able to operate safely and knowledgeably.
- Review the implement and instructions regularly with existing workers.



## PREPARATION

1. Grind safe - avoid underground utilities! Always contact your local utility companies (electrical, telephone, gas, water, sewer, and others) before starting work so that they may mark the location of any underground services in the area. Be sure to ask how close work can be done to the marks they positioned.
2. Inspect implement for shipping damage. If damage does exist, do not use. Notify your dealer immediately to have damaged parts replaced or repaired.
3. Assembly may be required depending on how you purchased your equipment. Follow the assembly procedures as outlined in the manual, ensure all hardware is secure.
4. When traveling on a public road at 32 km/h (20mph) or less, ensure a rear facing slow-moving-vehicle (SMV) emblem has been installed.
5. Ensure safety chain, straps, tires are not damaged and in good condition.
6. Inspect all fasteners that they are not loose or missing. Ensure fasteners are torqued according to the torque chart at the back of this manual
7. If traveling at night, ensure provincial state and local laws concerning lighting requirements have been met.
8. Ensure that all applicable safety decals are installed and legible.
9. Personal protection equipment (PPE) including hard hat, safety glasses, safety shoes, dust mask, and gloves are recommended during assembly, installation, operation, adjustment, maintaining, repairing, removal, cleaning, or moving the unit. Do not allow long hair, loose fitting clothing or jewelry to be around equipment.
10. **PROLONGED EXPOSURE TO LOUD NOISE MAY CAUSE PERMANENT HEARING LOSS!**  
Gas or diesel powered equipment can often be noisy enough to cause permanent, partial hearing loss. We recommend that you wear hearing protection on a full-time basis. Noise over 85dB on a long-term basis can cause severe hearing loss. Noise over 90db adjacent to the Operator over a long-term basis may cause permanent, total hearing loss.
11. When not attached to the tractor support the implement to prevent movement.

## WOOD DUST HAZARD

**Avoid Wood Dust Inhalation:** Exposure to wood dust has been associated with health issues due to the natural chemicals in wood or substances in the wood, such as bacteria, molds, or fungi.

Wood dust is considered carcinogenic to humans (Group 1) according to the International Agency for Research on Cancer (IARC).

Wood dust is also associated with toxic effects, irritation of the eyes, nose and throat, dermatitis, and respiratory system effects which include decreased lung capacity and allergic reactions.

**Wood Dust is Flammable:** wood dust can cause a fire or explosion if the particles are the right size and in the right concentration. Work only in well ventilated areas away from sources of ignition.

## STORAGE SAFETY

1. Store the unit in an area away from human activity.
2. Do not allow children to play on or around the stored implement.
3. Store the unit in a dry, level area. Cover if stored outside.
4. Guard any sharp corners including the cutting teeth of the rotor.
5. Ensure components and safety features are not damaged and in good condition before storing the implement. Make repairs now to be ready for the following season.
6. Secure the implement to prevent unwanted movement.

## OPERATION SAFETY

1. NEVER allow helpers or bystanders under or near the machine.
2. Make sure that the machine is fastened securely to the power unit before moving.
3. Inspect all fastening devices, do not use if worn or damaged.
4. Make sure that everyone is clear before moving the implement. NEVER position yourself between the tractor and the implement.
5. Do not permit riders while transporting this implement.
6. Where possible, avoid operating near ditches, embankments and holes.
7. Slopes are a major factor related to loss of control and tip-over accidents, which can result in severe injury or death. Operating the machine on any slope or uneven terrain requires extra caution.

## MAINTENANCE SAFETY

1. Good maintenance is your responsibility, follow the maintenance schedule. Poor maintenance is an invitation to trouble.
2. Follow good shop practices.
  - Keep service area clean and dry.
  - Be sure electrical outlets and tools are properly grounded.
  - Use adequate light for the job at hand.
3. Never work under or around the implement unless it is blocked securely.
4. Use personal protection equipment (PPE) such as eye, hand, foot and hearing protectors.
5. When attached to the power unit, never adjust, service, clean or lubricate the implement until all power is shut off.
6. Ensure hardware is torqued according to the torque chart at the back of this manual.
7. Disconnect battery ground cable before servicing any part of the electrical system.

## SAFE WORK AREA

Not all work spaces are the same, but the principles presented here can be applied to any work space.

Survey the work site, remove debris and make note of nearby or overhead obstructions, knowing your work area will make the clearing job easier and safer.

Where possible, avoid operating near ditches, embankments and holes.

For worker safety a prework site visit is recommended. Make a plan to identify hidden obstacles, structures and debris areas. Sudden impact from obstacles hidden under the surface may cause injury.

Be aware of:

**Bystanders** or any one not directly involved with the work are only allowed outside of the work area, minimized hazards.

**Workers** helping the operator must wear the appropriate PPE and must always make eye contact with the operator before entering the work area. Unauthorized Workers or bystanders are not allowed in the work area. Hazards are present.

**Operator**, do not operate the implement outside of the operator area.

## TRANSPORT SAFETY

1. Check power unit tires before proceeding:
  - Inflation - correct pressure
  - Tread - unusual wear, exposed cord
  - Rims - damaged or bent
  - Wheel bolts - all secure, not loose
  - Replacement tires must be same type and rating
2. Just before transport, perform a circle check to ensure everything is safe.
3. Be sure all markers required by local traffic regulations are in place, clean and working. SMV: required if traveling at 32 km/h (20 mile/h) or less on a public road.
4. If traveling at night, ensure provincial state and local laws concerning lighting requirements have been met. Lighting is not required for daytime transport, however generally lighting is required one-half hour before sunset to one-half hour after sunrise and at any other time when there is insufficient light or unfavourable atmospheric conditions.
5. Reduce speed when turning, crossing slopes and rough, slick or muddy surfaces.
6. Stopping distance increase with speed, weight and on slopes.

## HYDRAULIC SAFETY

1. Make sure that all the components in the hydraulic system are kept in good condition and are clean.
2. Before applying pressure to the system, inspect for leaks at all components, and that lines, hoses, connections and couplings are not damaged and leak free.
3. Do not attempt any makeshift repairs to the hydraulic lines, fittings or hoses by using tapes, clamps or cements. The hydraulic system operates under extremely high pressure. Such repairs will fail suddenly and create a hazardous and unsafe condition.
4. Wear proper hand and eye protection when searching for a high pressure hydraulic leak. Use a piece of wood or cardboard as a backstop instead of hands to isolate and identify a leak.
5. If injured by a concentrated high-pressure stream of hydraulic fluid, seek medical attention immediately. Serious infection or toxic reaction can develop from hydraulic fluid piercing the skin surface.
6. Turn off the power unit and relieve pressure on hydraulic system before maintaining or working on system.
7. All hydraulic work must be done by qualified personnel.

## PTO DRIVE-LINE SAFETY

1. Review and understand safety labeling on the PTO drive-line.
2. Be aware that the slip clutch end of the PTO may be very hot and could cause burns, use caution when working around the slip clutch.
3. Ensure the drive-line has been properly sized to accommodate the particular hitch and tractor combination.
4. Keep the guard tubes overlapped as much as possible during transport and operation or rotation.
5. Ensure that the profile tubes are not overextended. Under all working conditions, extension of the drive-line should not exceed the reported values in this manual. All rotating parts must be guarded.
6. Do not exceed the values given in this manual for permissible length extension. If greater telescoping ability is required, use a larger sized PTO drive-line.
7. Ensure that all drive-line and tractor shields are functional and in place before operation. Damaged or missing parts must be replaced with the original equipment spare parts and correctly installed, before using the drive-line.
8. All rotating parts must be guarded, contact with an unshielded rotating drive-line can cause death or serious injury.
9. Ensure the drive-line shield restraint chain is attached to the tractor master shield to prevent the shield from rotating.
10. Check that the drive-line restraint chain is trimmed to the correct length so as not to wrap around the drive-line shield.
11. Never use the restraint chain to support the PTO drive-line when not in use, the PTO shield could become damaged and will not perform as required.
12. To protect the PTO from damage or contamination, always use the PTO drive-line support when the unit is not in use.
13. Disengage the PTO, turn off the tractor engine, remove and pocket the key, and check that all rotating parts have come to a standstill before approaching the implement or performing maintenance work.
14. Tie back long hair and do not wear loose clothing, jewelry or anything which could get caught in the machines rotating parts.
15. Do not stand, lean, or otherwise come in contact with the drive-line. Do not step over or go under the drive-line.
16. Always connect tractor PTO to STATIONARY MACHINERY. Chock the tractor wheels to prevent rolling and check that joint angles are small and as equal as possible.
17. Do not approach, nor allow bystanders to approach the work area or rotating parts and drive-line.
18. Ensure drive line is rotating in the correct direction, as indicated in this manual.

# SAFETY LABELS

Safety labeling is an important part of the overall safe use of the implement. Safety labeling alerts and warns against potential injury or death, and is important to follow these points to help keep your implement safe for you and others who may be using it.

- Keep safety signs clean and legible at all times.
- Replace safety signs that are missing or have become illegible.
- Replaced parts that displayed a safety sign should also display the current sign.
- Safety signs are available from your authorized Distributor or the factory order desk.

## SAFETY LABEL DESCRIPTIONS



Caution: read and understand ALL safety and operating instructions in the manual, read and understand ALL safety labels located on the machine. The most important safety device on this equipment is an informed SAFE operator.



Warning: When attaching the spreader 3PH, to the power unit, stay clear of lower hitch arms lifting range while adjusting the 3 PH. Possible crushing, amputation or death.



Caution: when repairing or maintaining the unit ensure power unit is off and the key is removed and pocketed. Possible entanglement and amputation hazard.



Caution: Moving parts present a potential pinch hazard and could result in a serious injury. Use caution and be aware of parts as they are being moved or adjusted. Possible crushing and amputation hazard.



Caution: do not place your hand or any part of your body on or near the grinder wheel while the machine is in operation. Rotating parts are in motion and serious injury could result. Possible entanglement, amputation or death.



Caution: grinder blade causes flying material. Use caution and never grind toward people, buildings, vehicles or other objects. Possible laceration, bruises or impalement.



Caution: Personal Protection Equipment (PPE) is required when operating or maintaining this machine. Failure to wear PPE will result in personal injury.



Warning: Do not operate machine without PTO safety shields in place. Entanglement danger present, keep hands, loose clothing, and long hair away from spinning PTO. Possible entanglement, amputation or death..



Important: Be certain your tractor's PTO output is set-up to operate at 540 rpm. Do not exceed 540 rpm power take-off speed, injury or equipment breakage may result. Label indicates rotation as viewed from the label position.



Caution: Hydraulic fluid is under pressure, be aware that hydraulic leaks could develop with out warning. Do not check for leaks with your hand or fingers while the system is pressurized, serious injury could result. Possible burns or poisoning from pressurized fluid injection.

## IF LABELS NEED TO BE REPLACED:

- Be sure that the installation area is clean and dry.
- Be sure temperature is above 50°F (10°C).
- Determine exact position before you remove the backing paper.
- Remove the smallest portion of the split backing paper.
- Align the sign over the specified area and carefully press the small portion with the exposed sticky backing in place.
- Slowly peel back the remaining paper and carefully smooth the remaining portion of the sign in place.
- Small air pockets can be pierced with a pin and smoothed out using the piece of sign backing paper.

## SAFETY LABEL LAYOUT

Safety signs and locations on the equipment are shown in the illustrations below. .

Good safety practice requires that you familiarize yourself with the label and the safety message it is delivering. Be aware of the equipment or particular equipment feature that requires your SAFETY AWARENESS.

If safety labels have been damaged or removed, new labels must be applied. New safety signs are available from your dealer or contact Reist.

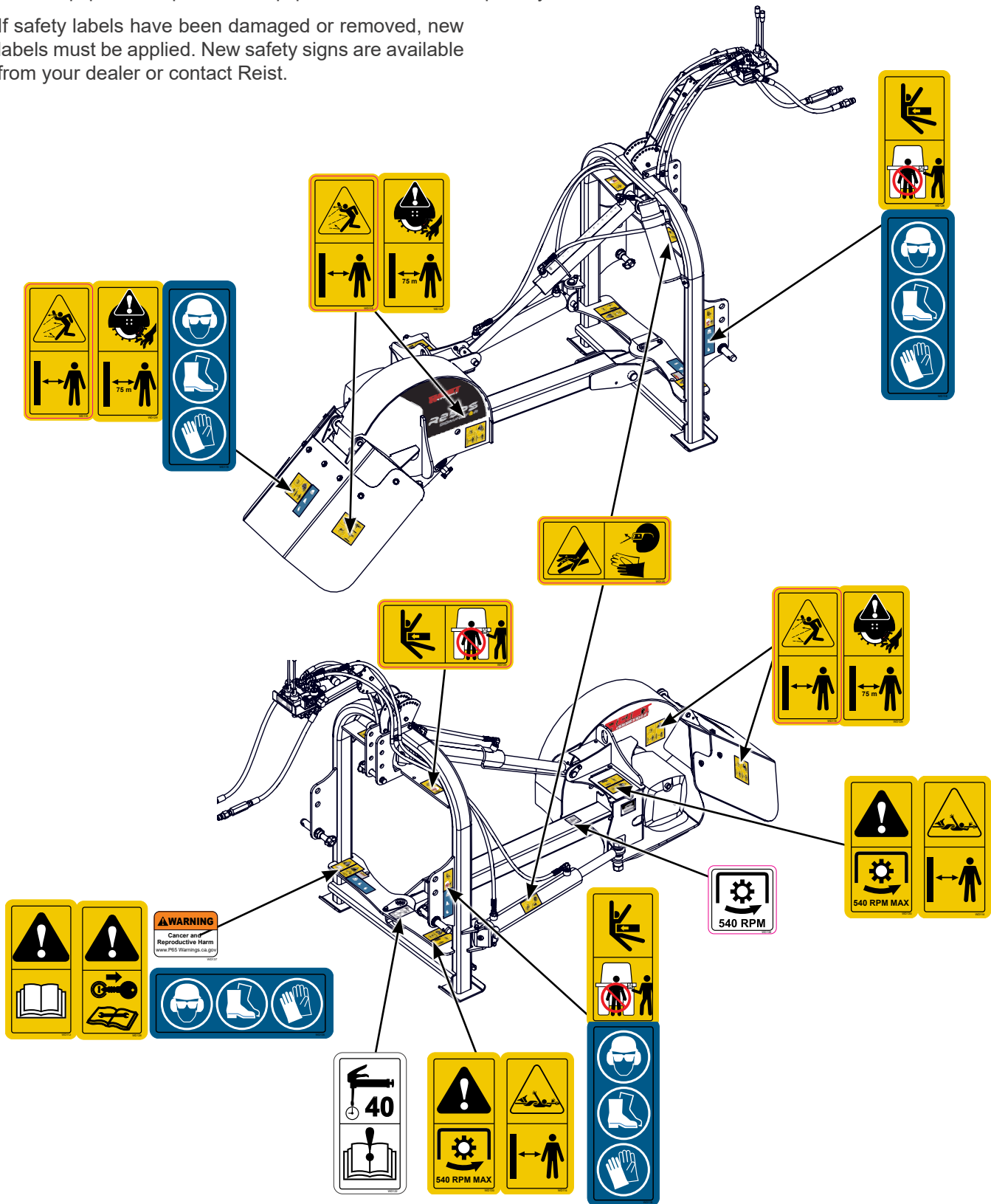

# SPECIFICATIONS AND DIMENSIONS

## SPECIFICATIONS

Stump Grinder Specs.	R25PSS	R25PSV
Recommended PTO HP	25-80 HP	
PTO (input speed)	540 RPM	
Rotor Size	25"	
Tooth Construction	Replaceable Three Sided Carbide Bolt into Pocket	
Number of teeth	18	
Cutting Wheel rotation	Clockwise Rotation (standing on the right side of the grinder)	
Cutting Wheel Speed	1,026 RPM	
Cutting Height (above grade)	20"	
Cutting Height (below grade)	6"	
Cutting Depth (per pass)	2.25"	
Cutting Width (per pass)	22"	
Swing Arc	55°	
Drive-line Protection	PTO Slip Clutch	
Three Point Hitch	Rear Mount 3PH CAT I & II	
Quick Hitch Compatible	Yes	
Hydraulic Remotes Required	2	1
Hydraulic Valve (Lift & Swing)	No	Standard
Weight	950 LBS.	
Length	86"	
Width	39.25"	
Height	46.0"	71.0"

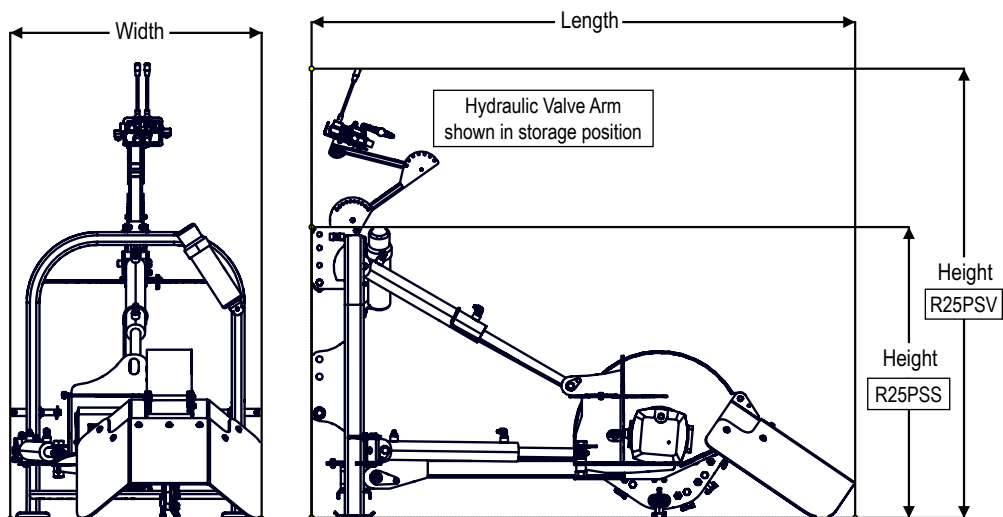

## INSPECTION

After receiving your machine, inspect machine for damaged or loosened parts. If damaged or loosened parts exist, do not use. Notify your dealer immediately to have affected parts replaced or repaired.

# COMPONENTS AND FEATURES

The Reist Industries **R25PS Series Three Point Hitch Stump Grinder** is designed and manufactured to meet the needs of a discriminating buyer for efficient grinding of stumps.

The owner or operator has the responsibility of being familiar with all the features of the R25PS series and know how to operate it. Each owner or operator must train all other operators before they start working with the machine.

Read this section carefully to learn how to use the stump grinder safely and how to set it to provide maximum field efficiency. By following instructions in conjunction with a good maintenance program, your R25PS series stump grinder will provide many years of trouble-free service.

Do not operate this machine if you are not familiar with its features.

The R25PSV is illustrated below, showing its basic components and features and are similar for the R25PS series unless noted otherwise. Review the various components and their position, the names of the components will be used to describe where they are and how they work through out the manual.

## ROTOR VIEW

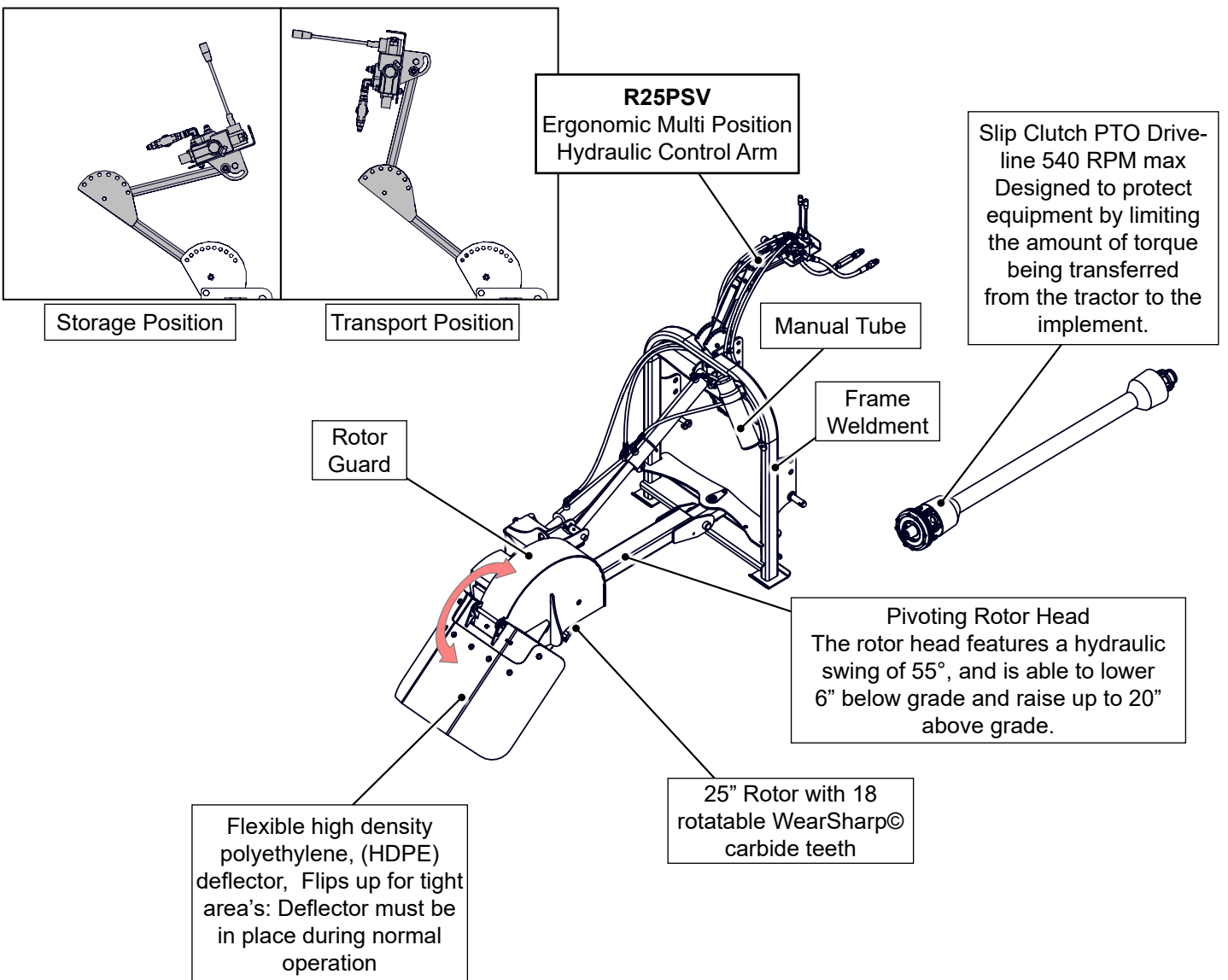

## FRAME VIEW

The R25PSV is illustrated below, showing its basic components and features and are similar for the R25PS series unless noted otherwise. Review the various components and their position, the names of the components will be used to describe where they are and how they work through out the manual.

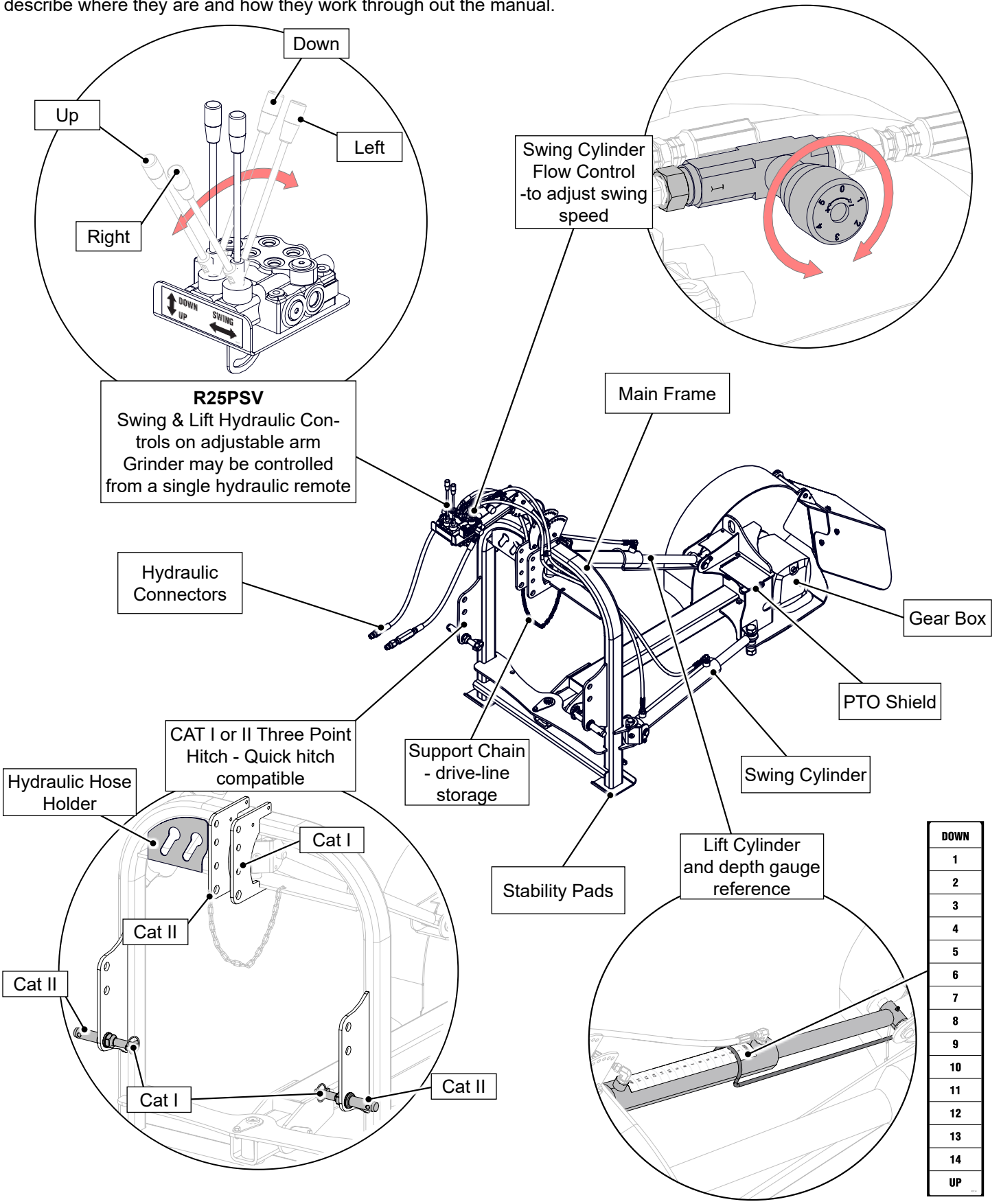



# INITIAL SETUP

The initial setup of the R25PS series Stump Grinder assembly involves some basic steps. To prevent potential injury during installation and to ensure safe working conditions, avoid working around the tractor while it is running. Shut off the tractor and ensure the brakes are applied or the wheels have been secured with wheel chocks to prevent unwanted movement during the installation process.

Ensure you torque the bolts according to the torque chart in the back of this manual. This is a one time set up procedure, and will not have to be repeated.

## HDPE DEFLECTOR INSTALL

The R25PS Series Stump Grinder is shipped partially assembled, and requires that the HDPE (high density polyethylene) deflector be assembled to the main unit.

- Ensure the stump grinder sitting level and is secure from tipping.
- Remove the deflector mounting hardware from the deflector mount flange on the grinder.
- Fit the deflector on the mount flange of the grinder
- Install the guard pin weldment, secure with the 3/8 bolt and hex nut as shown in the diagram, and hand tighten.
- Torque hardware per torque chart in the back of this manual.

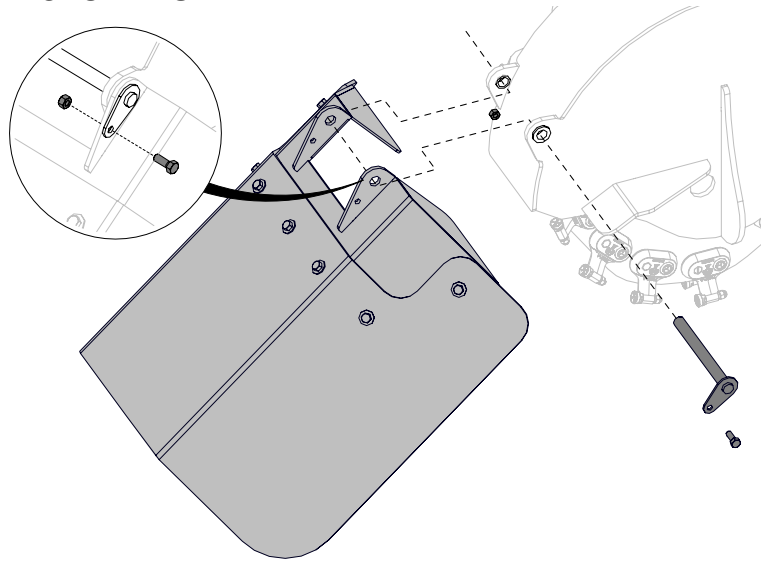

## PREPARE THE QUICK HITCH

The R25PS Series is Quick Hitch compatible. Purchase and install your quick hitch system at this point to make attachment easier.

Follow the instructions that came with your quick hitch system to assemble the quick hitch to the stump grinder. Test fit the assembly to the tractor. Test fitting ahead of time ensures a safe and secure attachment to the tractor with no surprises.

Check that all pins and latches are in good shape and hold the grinder securely to the tractor.

**WARNING**  
**Pinch Hazard**

Keep hands away from mounting points while attaching to the power unit. Potential pinch hazard exist between the machine and power unit



## CHECK GEARBOX OIL LEVEL

Gearbox oil level should be checked before first startup and every 200 hrs there after. It is recommended the units be run for a period of time (4 to 10 hours) under no or light load conditions as installed. This will promote proper wear-in and alignment of all mating components.

To check the oil level, on the R25PS series Stump Grinder,

- Lower the grinder to the ground so that the grinder is level.
- Remove the level check plug.
- Oil must be level with the check plug hole.

To add oil,

- Remove the fill plug
- Add oil until it starts to come out of the level check hole.
- Reinstall the level check and fill plugs.

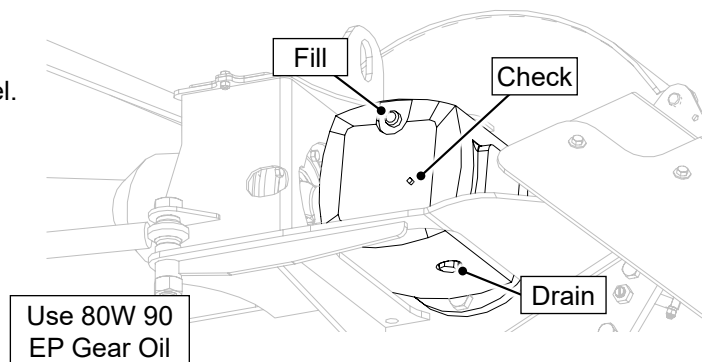

## SIZING PTO DRIVE-LINE

The PTO drive-line as supplied with the machine will need to be checked for the proper length before being put into service.

To accommodate the various hitch and tractor configurations the supplied length drive-line shaft may need to be shortened. The PTO drive-line must be free to telescope and not bottom out when going through its working range. It should never completely collapse in use and there should always be 2" of clearance to retract.

 If the drive-line bottoms out, the bearings on both ends can be overloaded and could fail causing damage or injury.

Follow these guidelines to insure good fitment:

- Use a sharp hacksaw to cut the PTO tube.
- Use a fine file to remove any sharp edges and burrs from sawing.
- Clean off all dirt and filings from tube, carefully test for smooth fit.
- Apply a light coat of grease to the outside of the small tube.
- Cut the plastic shields slightly shorter to make assembly easier.
- Install the PTO drive-line with the slip clutch at the stump grinder input.

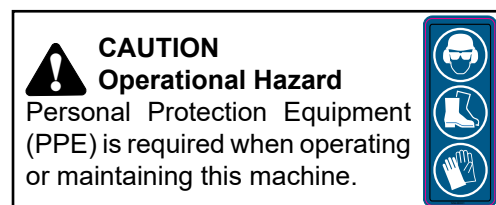

### To determine the correct drive-line shaft length:

- Fully collapse the drive-line and measure the distance between the locking yokes: Dimension 'A'
- Raise or lower the equipment until the PTO output shaft of the tractor is horizontal with the PIC input shaft on the machine.
- Measure lock-pin groove to lock-pin groove or bolt hole on the equipment to find the dimension 'B', and subtract 2.0" (for clearance).  
**'Length - 2.0" = B'**
- Compare measurements: if the collapsed length 'A' is longer than dimension 'B', the PTO shaft must be shortened.
- Subtract 'B' from the uncut PTO shaft measurement 'A'.
- The result: dimension 'C' is how much BOTH halves of the PTO shaft need to be shortened.  
**'A - B = C'**
- The difference of these measurements needs to be cut from **Both Halves** of the PTO shaft.
- Pull the PTO shaft apart, then measure and cut dimension 'C' from both the outer plastic covers and the inner metal tubes.
- Reassemble the drive-line.
- Install on equipment and check for fit and function, follow the procedure under 'Prepare the Drive-line'.

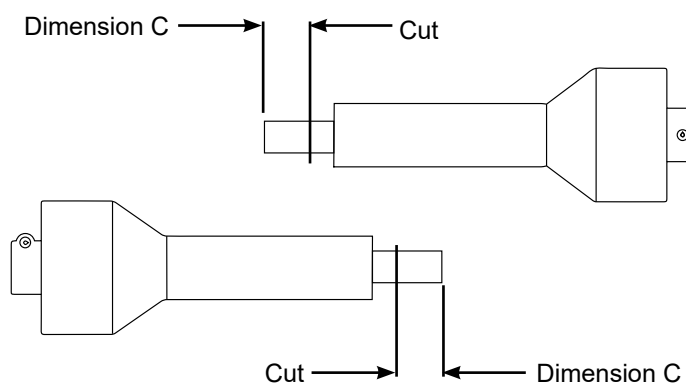
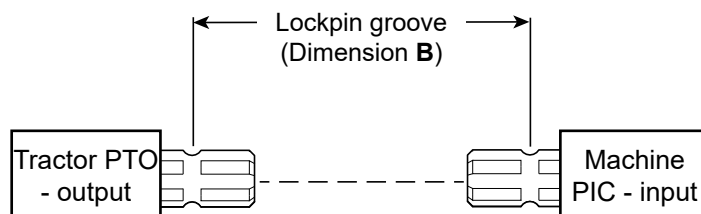
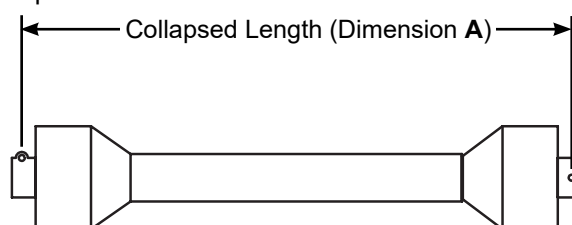

## PREPARE THE DRIVE-LINE

### PTO DRIVE-LINE CLUTCH PREPARATION

The slip clutch must be adjusted before first use or after a storage period. The clutch can become locked up over time or due to dirt, corrosion or condensation even if the implement is stored indoors.

Disengage tractor PTO, shut off engine and remove key. Have the stump grinder mounted and the drive-line not installed, and follow the steps below before using your stump grinder to ensure the PTO drive-line clutch plates are set properly.

**!** This procedure should be performed periodically as the clutch plates can stick together, particularly after periods of inactivity. Stuck plates prevent the clutch from slipping during operation as designed, resulting in high loads and possible damage to the steel shaft or tractor drive components.

- At the clutch end, using a marker, scribe a line across the exposed edges of the hub clutch plate and friction discs.
- Loosen each compression nut exactly two revolutions to free up the clutch friction discs.
- Install the drive-line.
- Start tractor and run drive-line at a low idle to slip the friction discs. This will remove any the dirt and corrosion on the clutch plate faces.
- Disengage tractor PTO. Shut off engine and remove key.
- Inspect the clutch and ensure that the scribed markings on the disc and plates have changed position. If any two marks are still aligned, that is an indication that these discs have not slipped. Repeat steps 4-5.
- If any markings have not moved, disassembly may be required to free up the disks.
- After ensuring all discs are free, tighten the compression nuts uniformly in a star pattern, exactly two revolutions each to reset the clutch to original pressure. (see spring height diagram in maintenance for reference)
- The clutch should be checked during the first hour of use and periodically each week thereafter.
- Be aware of unusual clutch plate slippage, burning odor, or visible smoking, further adjustment may be required.

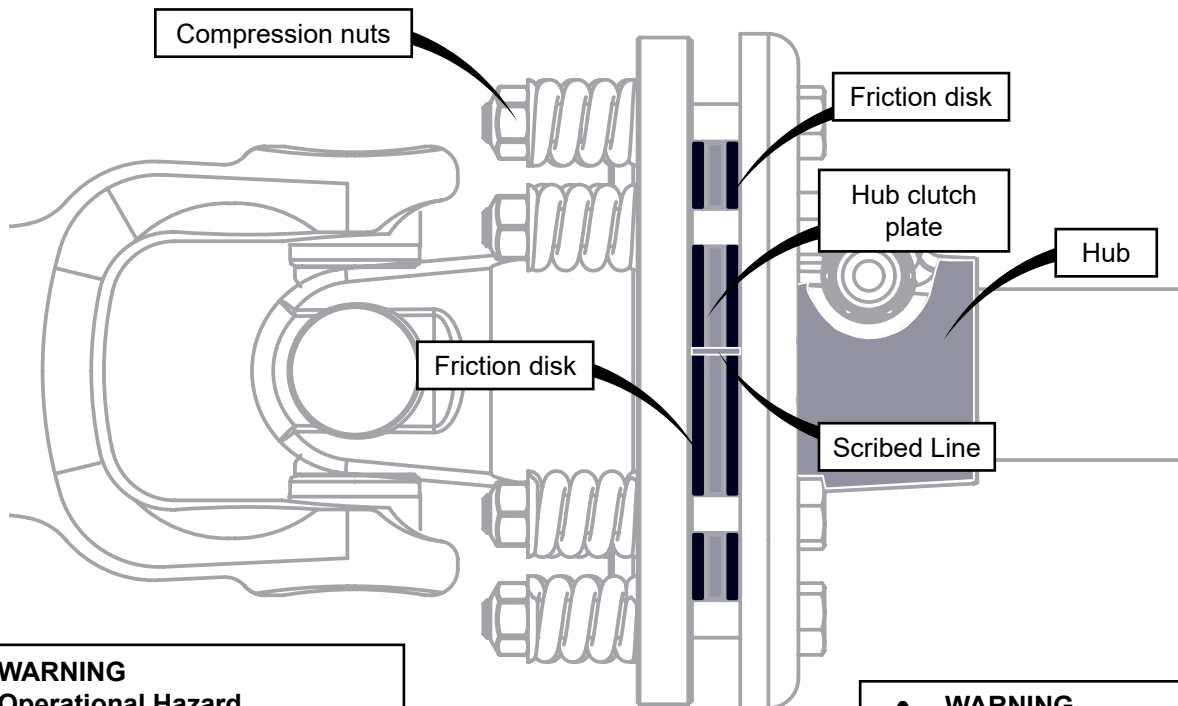

#### WARNING

##### Operational Hazard

The clutch should be checked periodically each week. Excessive clutch plate slippage, burning odour, or visible smoking should not be observed during use.



#### WARNING

##### Operational Hazard

To protect the PTO drive-line from damage or contamination, always use the PTO drive-line support when the unit is not in use

## PTO & HYDRAULIC TEST INSTALLATION:

Before proceeding, see the 'Sizing PTO Drive-Line' section to ensure your drive-line is properly sized.

- Ensure the stump grinder is on a level surface.
- Move the tractor up to the stump grinder and attach the tractor 3PH arms (CAT I, CAT II or quick hitch if installed) to the grinder.

**Note:** CAT I top link pin is not included and is the responsibility of the owner.

- Connect the grinder hydraulic connectors to the tractors remotes (see tractor's operator manual), ensure the hydraulic hoses are free from stretching, binding or pinching.
- Slowly lift the grinder until the input shaft is at the same height as the PTO output shaft on the tractor.
- Apply multipurpose grease to the output shaft, collapse the PTO drive-line completely.
- Attach the drive-line to the tractor output, pushing the spring-loaded snap ring in and sliding the yoke onto the tractor spline until the ring snaps into place.
- Apply multipurpose grease to the grinder input shaft,
- Slide the clutch end of the drive-line to the grinder input shaft, tighten the spline bolts to lock the drive-line in place.

 **If the drive-line cannot collapse far enough to slide it on the input and output shafts then the drive-line has to be shortened! (for more information see 'Sizing PTO Drive-Line' page)**

- Make sure the plastic shield is free to rotate on the PTO drive-line, and attach the shield restraint chain to the tractor PTO master shield.
- Lift and lower the 3PH arms to determine that the overlap on the PTO drive-line is never less than 1/3 of the shaft length, if it is too short then the PTO drive-line will jam rather than collapse.

### CAUTION Operational Hazard

Always connect the PTO guard restraint chain before operating the PTO. The restraint chain keeps the guard from rotating during normal operation and prevents objects and operator clothing from becoming entangled.

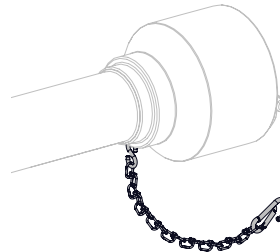

Check that the drive-line restraint chain is trimmed to the correct length so as not to wrap around the drive-line shield.

 **Jamming will put severe strain on the gearbox and PTO drive-line. The PTO drive-line may separate, resulting in an uncontrolled wild spinning of the PTO shaft, causing severe injury or death!**

- Make sure PTO does not bottom out at any point when lifting or lowering the grinder. PTO shaft should not come within 2" of the yoke at any time.
- Raise the grinder off the ground, make sure any bystanders are well away from the machine.
- Adjust the top link so that the R25PS frame weldment is 90° (perpendicular) to the ground. Adjusting top link will help keep the drive-line at acceptable angle (17° or less) during operation.

 **Operating the PTO drive-line at angles greater than 17° can cause premature wear and damage to the drive-line.**

- Lower the grinder so the stability pads are resting firmly on the ground.

### WARNING Operational Hazard

Do not place your hand or any part of your body on or near the grinder wheel while the machine is in operation. Rotating sharp parts are in motion and serious injury could result.



### CAUTION Operational Hazard

Tractor PTO must operate at 540 RPM only. Exceeding the grinders design speed of 540 RPM will result in operator injury or damage to the machine.



**Continued:**

- Verify that the hydraulic hoses are clear of any potential pinch points.
- Use the hydraulics to carefully move the grinder through the full range of swing and lift motion, check that the hydraulic hoses are free and clear at all times, ensure the PTO drive-line moves freely and easily with out binding.
- Secure the hoses to the top of the frame if necessary. Hose routing will depend on your specific tractor.
- Hydraulically lift the rotor head to clear the ground.
- Engage the PTO briefly and slowly start the grinder, ensure that everything is turning freely and all pins are secure and guards in place.
- Disengage the PTO, shut down the tractor, wait for all moving parts to stop.

**CAUTION**  
**High Pressure Hazard**  
Be aware that hydraulic leaks could develop with out warning. Do not check for leaks with your hand or fingers while the system is pressurized



 **Proper hose routing is the responsibility of the operator. Hoses must be free from stretching, binding or pinching. Pinching**

**CAUTION**  
**Operational Hazard**  
Personal Protection Equipment (PPE) is required while working in and around this machine.



## ADJUSTABLE ARM - R25PSV

The R25PSV includes a dual hydraulic valve on an adjustable arm which allows the controls to be situated close to the operators position on the tractor seat.

To prevent potential injury during installation and to ensure safe working conditions,ensure the grinder is on level ground and is secure to prevent unwanted movement during the installation process

### ARM POSITIONING

- Remove the lock pin from the lower arm attach plate, pivot the arm to the desired position and replace the lock pin.
- Remove the lock pin for the upper arm joint plate, pivot the arm to the desired position and replace the lock pin.
- Loosen the valve plate bolt, adjust the valve plate to desired position then tighten the bolt.
- Retract the adjustable arm during transport.

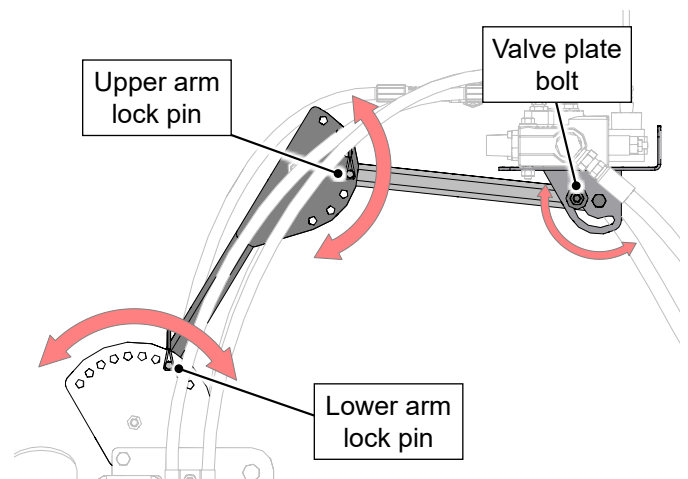

**Always retract the arm when using the three point hitch. The adjustable arm may contact operator or tractor when stump grinder is raised with the three point hitch. Place adjustable arm in retracted transport position before raising stump grinder.**

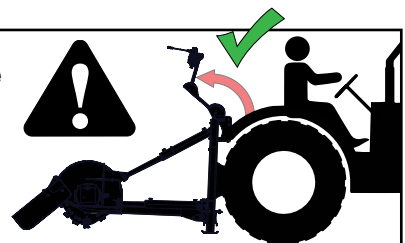

## FIELD OPERATION

This section describes how to safely and effectively operate the R25PS Series Stump Grinder in the field of operation. By following recommended procedures, a safe working environment is provided for the operator, bystanders and the area around the work site. Not all situations and conditions can be addressed, proceed with care & caution and use safety as your guide.

Lightweight power units may need weight added to the front or rear (depending on your configuration) to maintain steering control and prevent forward / rear tipping or side tipping caused by a heavy load. Consult your power unit's Operator's Manual to determine proper weight requirements and maximum weight limitations. Stump grinder performance may vary due to material conditions and type & density of material. Ensure rotor rotation is correct: clockwise.

**The owner or operator** has the responsibility of being familiar with the operation of the R25PS series and must train all other operators before they start working with the machine.

Wear appropriate breathing protection from wood dust and if the work site contains silica, chemicals or other materials that become hazardous when airborne.

Work in a safe manner and follow all instructions exactly, safety is everyone's business. Untrained operators are not qualified to use the machine.

### OPERATION SAFETY CHECKLIST

- |   |  |
|---|--|
| ✓ Avoid wearing loose clothing, scarves, jewelry or anything that may get caught in rotating parts.                   | ✓ Be aware of underground utilities! Ensure local utility companies have inspected and marked the location of any underground services in the area. Be sure to ask how close work can be done to the location marks. |
| ✓ Make sure that the machine is securely mounted before using.  | ✓ Wear adequate safety gear, including dust mask, safety glasses with side shields, appropriate hearing protection and protective gloves.  |
| ✓ Do not allow you or anyone to place hands or any body part on or near the machine while the machine is in operation | ✓ Do not operate a unit during or after the use of medication, drugs or alcohol. Safe operation requires your complete and unimpaired attention at all times.  |
| ✓ Do not permit riders while using or transporting machine  | ✓ Operate only when there is good visibility and light.  |
| ✓ Do not allow bystanders near front or sides of the machine. Flying objects could be ejected at high speed.          |  |

### PREPARE

- Clear the area of bystanders, especially small children.
- Training: each operator must be trained and familiar with the set up and operation of the product and its components.
- Review:
  - Components and Features.
  - Operation Safety Checklist.
  - Power unit safe operating instructions.
  - Connection procedures: PTO, 3PH attachment.
- Survey the work site, remove large debris and make note of nearby or overhead obstructions.
- The stump should be cut as close to ground level as possible
- Check PTO drive-line guards to make certain they are in good working condition and in place.
- Before use, inspect the machine (see service & maintenance section) and check the following:
  - Inspect your power unit, it must be in good operating condition (see power unit owner manual).
  - Check all cutting teeth, pins, nuts, bolts and screws and ensure they are all properly secured.
  - Ensure the rotor is spinning in the correct direction. (clockwise)
- It is recommended that each person wear appropriate Personal Protective Equipment (PPE). This list includes but is not limited to:
  - Dust mask appropriate for the material.
  - Safety shoes with slip resistant soles.
  - Safety glasses.
  - Hearing protection.
  - Heavy or leather gloves.

## MOUNT THE STUMP GRINDER

Ensure your attachment system is secure on the power unit. Mounting procedure will vary based on system used: 3PH CAT I, CAT II or quick hitch if installed.

**Note** CAT I top link pin is not included and is the responsibility of the owner.

Verify there is sufficient visibility and maneuverability to move up to stump grinder. The stump grinder should be in position according to the power units mounting instructions. Verify pins are secure in the correct position.

- Support the drive-line and remove and stow the drive-line support chain
- Attach tractor's 3PH arms (or quick hitch) to the stump grinder: refer to the tractor operator's manual or quick hitch instructions.
- Raise the stump grinder off the ground slightly.
- Align the splines and push drive-line onto PTO output until it snaps securely into place, pull back on drive-line to make sure it is locked on tractor PTO shaft.
- Confirm the spline bolts at the slip clutch are installed and secured to the stump grinder.
- Attach the PTO drive-line restraint chain to the tractor master shield.

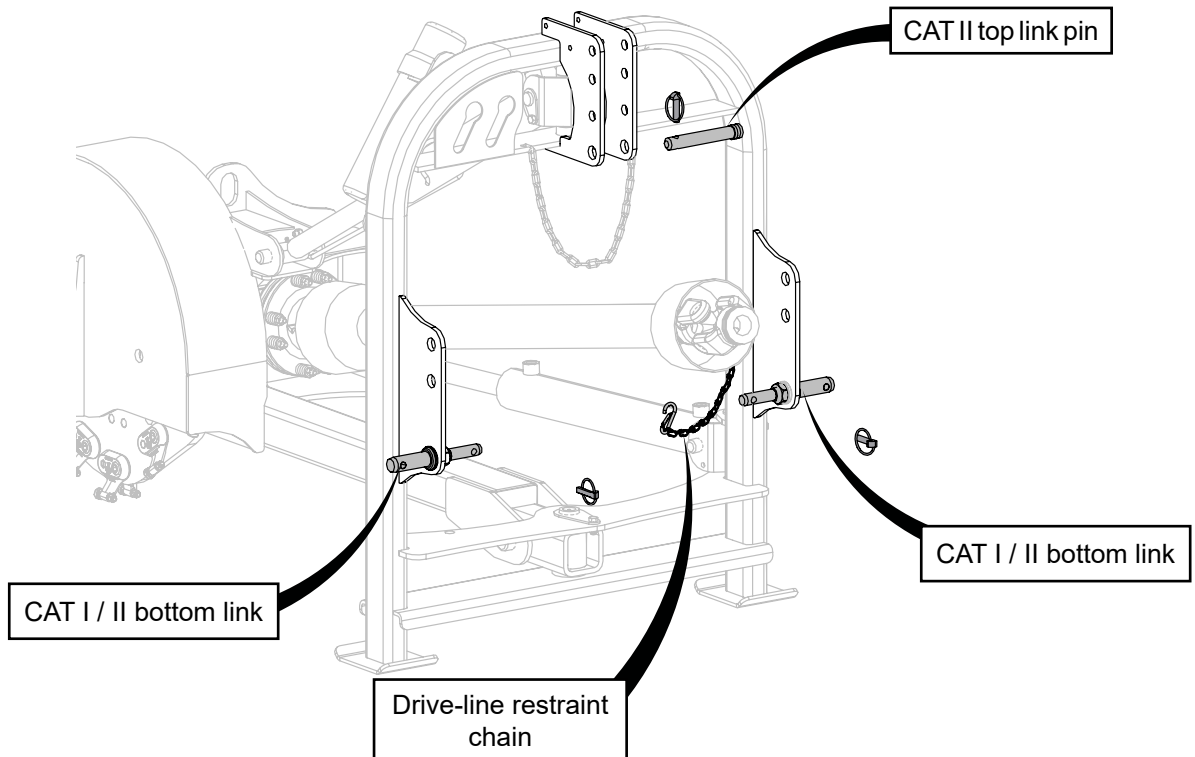

### WARNING Pinch Hazard

Keep hands away from mounting points. Potential pinch hazard exist between the implement and power unit.



### CAUTION Operational Hazard

Tractor PTO must operate at 540 RPM only. Exceeding the grinders design speed of 540 RPM will result in operator injury or damage to the machine.



**540 RPM**

## OPERATING THE STUMP GRINDER

Ensure your PTO is off, all pins and safety shields are secured and grinder is slightly raised. Inspect the work site and be aware of any underground utilities. Check the slip clutch is not locked up from inactivity. **(see maintenance: Drive-line)**

**OPERATOR ORIENTATION** - The directions left, right, front and rear, as mentioned in this section, are as seen from the tractor driver's seat and facing rearward, unless mentioned otherwise.

Stump grinding is always right to left across the stump with rotor rotating clockwise into the stump, and the tractor is stationary. Always lower cutting wheel beside the stump, then begin the pass. Do not try cutting down, always cut using the swing mechanism.

When grinding softwoods the R25PS series may be able to remove up to the maximum 2.25 in. (57 mm) material per pass. However, hardwoods are more dense and the depth of grind may be much less. Adjust as required, the first pass will determine the optimum depth.

### START THE GRINDING PROCESS

- Use hydraulics and raise the rotor head to clear the stump.
- Orient the tractor so that it is centred with the stump.
- Position the grinder up over the stump so the rotor head is centred at the front edge. (the edge that is closest to the tractor),
- Swing the rotor head all the way to the right.
- Check the position of the stump grinder to the stump, lower the stump grinder so it rests on the stability pads. Set your parking brake. This is your starting position.
- Adjust the swing speed flow control to a slow setting.
- At idle engage the PTO, increase PTO RPM and bring cutting wheel up to speed and slowly lower it in a controlled manner to the optimum grinding depth. Make note of the position on the depth gauge.
- Slowly begin the rotor head swing from right to left, cutting into the stump for your first pass.
- Adjust the swing speed flow control as required to obtain a good cut.
- After a complete pass move the rotor head back to starting position and lower the rotor head, use the depth gauge as reference

Continued on next page



**For clarity some illustrations in this section show the guards removed. Never operate the stump grinder with any guards removed.**

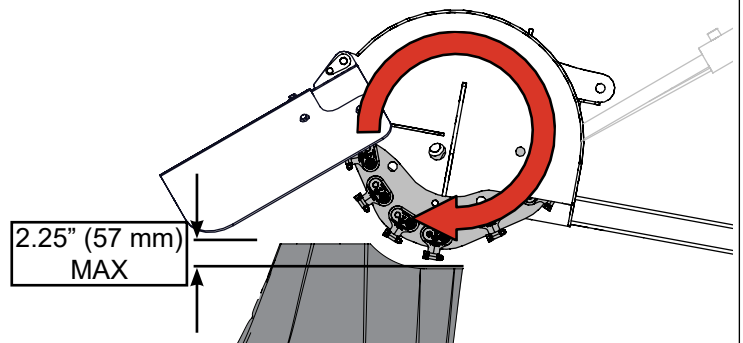
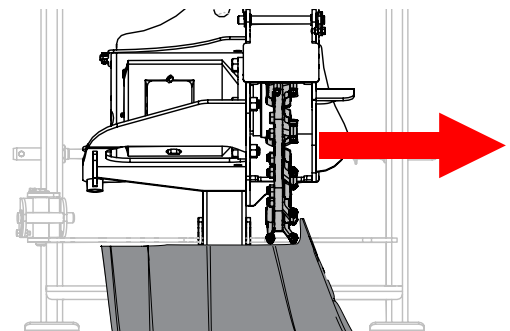
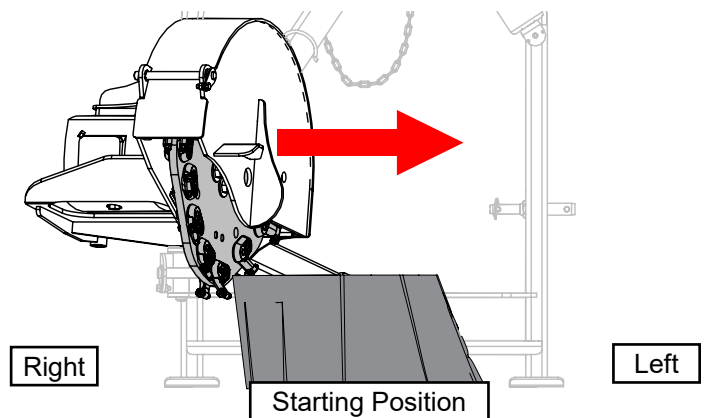

#### **WARNING** **Operational Hazard**

Do not place your hand or any part of your body on or near the grinder wheel while the machine is in operation. Rotating sharp parts are in motion and serious injury could result.



#### **CAUTION** **Operational Hazard**

Do not operate or transport on steep slopes. Use extreme care and reduce ground speed and do not stop, start, or change directions suddenly on slopes.



**Continued:**

- Continue passes from right to left and lowering until ground level is reached.
- Grind down below ground surface up to 6.0 in. (178 mm) below the surface to where the stump roots branch out, be aware of hard objects in the dirt.

 **Keep a look out for hard foreign objects below grade. Rocks or buried metal can damage or break the teeth resulting in poor grinding performance.**

- Throttle down the tractor to an idle, disengage tractor PTO.

**IF THERE IS REMAINING STUMP:**

- Raise the grinder slightly off the ground,
- Hydraulically lift the rotor head to clear the stump,
- Disengage the parking brake, move the tractor backward, so that the centre of the rotor is over the uncut edge, engage parking brake.
- Swing the rotor back to starting position and lower cutting wheel to the optimum grinding depth
- Engage the PTO, bring cutting wheel up to speed and begin the pass.
- Repeat the grinding process until stump removal is complete.
- Throttle down the tractor to an idle, disengage tractor PTO.
- Shut off engine and remove key.

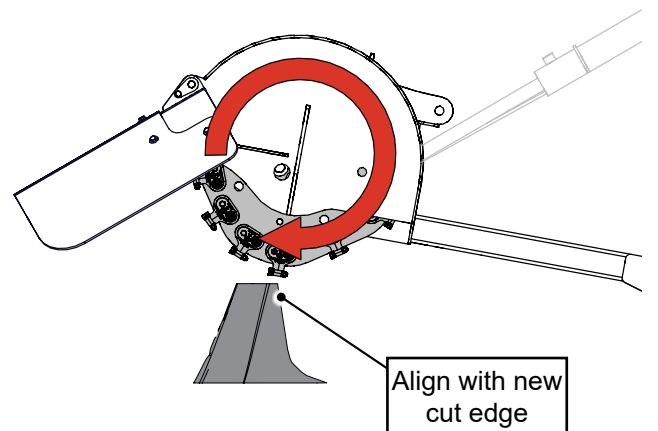
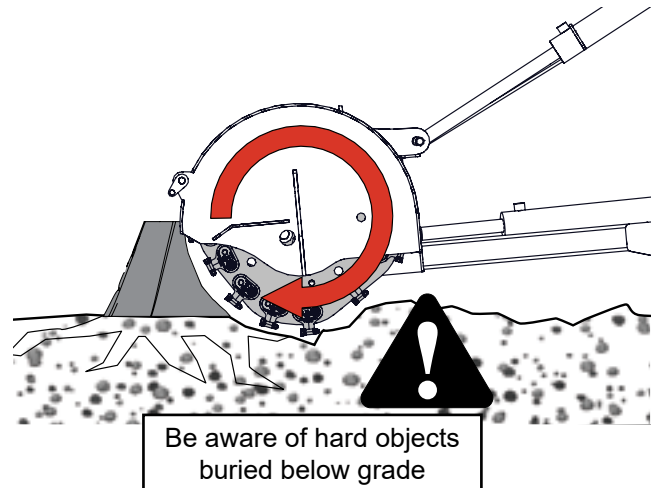

## R25PS SERIES USER TIPS

- Before you begin, make sure the tractor is turned off and the PTO drive is disengaged then inspect the work site.
- Check that the area around the stump is free from stones and metal, visible or concealed, to prevent damage to the stump grinder.
- Familiarize yourself with the view of the stump grinder from the tractor seat.
  - Stand to the side of the stump grinder and observe the center point on the bottom of the cutting wheel.
  - Now sit on the tractor seat and observe the center point again.
  - Orient yourself with the rotor position from the operators seat.
  - Never attempt to operate the grinder when not in the operators seat on the tractor.
- The stump grinder should never be run through the centre of a stump or be ground front to back. This will induce severe vibration and cause the grinder to bounce dangerously.
- Many variables, such as the type of tree, age, size, amount of moisture, and condition, affect the required amount of time and effort to grind a stump.
- Test all operating functions in an open area with the tractor at idle speed to get a feel for the controls.
  - Start with a small stump, and take your time. The cutting wheel is shielded from view when sitting on the tractor seat so it is difficult to accurately determine the progress.
  - Make the first pass, disengage the PTO drive and check the progress, exit the tractor to see how much you have removed.
  - Check progress after each pass.
  - The ability to judge the positioning improves with practice and experience.
- Operation should be smooth and grinding should be done gradually.
- In areas where debris from the stump grinder needs to be contained use a debris screen. A debris screen is available from your dealer or Reist order desk: **# DS510 Debris Screen 10'x5' (4 posts)**.
- If the stump grinder begins to bounce or is vibrating heavily, it means either the rotor head is swinging faster than the grinder can remove material or that too much material is being removed per pass. If this is the case, immediately stop swing motion and adjust for a shallower cut and if necessary adjust the swing flow control and take a slower pass.
- Applying too much force will shorten the life of the cutting teeth and may damage the stump grinder.
- If the stump is on a grade, position tractor lower on the grade with the rotor on the stump grinder higher up the grade.
- All cutting is done on the left side of the rotor, not the bottom of the rotor. Always swing the rotor through a stump right to left.
- Follow the root system, taking as much of the larger surface roots as possible. If these are not removed they can eventually protrude from the ground in areas where there is a heavy freeze/ thaw cycle.
- Never operate stump grinder when other people are in the vicinity.
- Always use full throttle (maximum engine speed), but do not exceed 540 rpm on the PTO.
- Check the condition of the grinding teeth before each job.
- Be sure to lift the rotor head and main frame anytime you are transporting the stump grinder.
- Be aware the slip clutch may 'lock up' and require adjustment if not used for a period of time. See the maintenance section.
- Be prepared for potential machine "kickback" when initially contacting the stump.

# STORAGE

## STORAGE SAFETY CHECKLIST

- ✓ Store the implement away from work area's and livestock.
- ✓ Do not permit children to play on or around the stored machinery.
- ✓ Secure the implement to prevent unexpected movement.
- ✓ Ensure all pins, latches and locks are secure.
- ✓ Guard any sharp corners.

After the season's use or when the machine will not be used for a period of time, completely inspect all parts of the stump grinder. Replace or repair any worn or damaged components to prevent any unnecessary down time at the beginning of the next season. Your implement is an important investment. Spending some time to protect it from rust and corrosion will result a safer, longer service life and better performance..

## PREPARE FOR STORAGE:

1. Thoroughly wash the machine with a pressure washer or water hose to remove all dirt, mud or debris.
2. Remove all remaining material and debris from the machine.
3. Inspect for damaged or worn parts. Repair or replace before next season.
4. Replace any missing or unreadable safety decals.
5. Repaint any chipped or scraped areas to prevent rust and corrosion.
6. Perform a maintenance on the grinder.

 **CAUTION**  
**Operational Hazard**  
When repairing or maintaining the unit ensure power unit is off and the key is removed and pocketed.



## PLACING IN STORAGE:

1. It is best to store the machine in a inside area. If that is not possible, cover with a waterproof tarpaulin and tie down securely.
2. Use a flat, level, dry and clean storage area.
3. Use the tractor to position the stump grinder in the storage area.
4. Lower the rotor head to mid point, and lower the main frame so it rests on the stabilizer pads.
5. To help protect the cutting teeth place a board or similar under the teeth that are resting on the floor.
6. Lower the stump grinder onto storage area.
7. Disengage the PTO, turn off the tractor engine, remove and pocket the key, and check that all rotating parts have come to a standstill before approaching the implement.
8. **Hydraulics:** operate the valve control to relieve any pressure, and carefully disconnect the hydraulic connectors and store in the hose hangers.
9. **R25PSV:** Remove the lock pins that secure the adjustable arms and place it in storage position.
10. Disconnect the PTO drive-line.
11. Remove the stump grinder from the tractor's 3-point hitch system.
12. To protect the drive-line from damage or contamination always use the PTO drive-line support chain when the unit is in storage, cover the exposed PTO shaft end.



### CAUTION

#### Heavy or bulky parts

Prevent potential strain injury, use approved lifting equipment or ask for help when lifting or moving heavy, bulky parts.



### WARNING

#### Puncture Hazard

Rotor teeth have sharp edges, cover and protect from people coming in direct contact, serious injury could result.

# SERVICE & MAINTENANCE

Good maintenance is your responsibility. Poor maintenance is an invitation to trouble.

To keep your Reist Stump Grinder in good working condition, and increase bearing life as well as maintain ease of operation, periodic lubrication is essential. This also helps to flush out moisture and dirt.

By following a careful service and maintenance program for your machine, you will enjoy many years of trouble-free operation.

Replacement of parts should be done by a qualified personnel only. Keep a record of all maintenance, to ensure scheduled inspections and maintenance are performed.

## MAINTENANCE SAFETY CHECKLIST

- ✓ Follow good shop practices.
- ✓ Keep service area clean and dry.
- ✓ Use adequate light for the job at hand.
- ✓ Never work under equipment unless it is blocked securely
- ✓ Parts replacement should be performed by qualified personnel to ensure safe and complete installation.
- ✓ A fire extinguisher and first aid kit should be kept readily accessible.
- ✓ Always use personal protection devices such as eye, hand, foot and hearing protectors.
- ✓ Use heavy gloves when handling heavy or sharp components.
- ✓ When replacing parts, ensure hardware is properly torqued.

## GENERAL MAINTENANCE

Before lubricating and inspection, ensure the grinder is clean and free of debris. Check under the HDPE Deflector, rotor hood and around the PTO drive-line and clean out any material buildup.

On a regular basis check all nuts, bolts and screws and ensure they are all properly secured.

The PTO slip clutch must be inspected and adjusted before first use or after a period of storage. The clutch can become locked up over time or due to dirt, corrosion or condensation even if the implement is stored indoors. Lock up can prevent the clutch plates from slipping during operation, resulting in high loads and possible damage to drive-line, implement or tractor components.

## GEARBOX MAINTENANCE

Gearbox oil level should be checked every 200 hrs.

Oil should be changed after the first 50 hours of operation, and 1000 hours or yearly thereafter. Shorter oil change intervals may be required if the unit operates at high temperatures or at maximum load conditions.

During oil changes, care should be taken to ensure oil is collected properly and avoid spillage. Waste oil should be disposed of properly and according to local requirements.

**To check the oil level,** on the R25PS series Stump Grinder,

- Lower the grinder to the ground so that the grinder is level.
- Remove the level check plug.
- Oil must be level with the check plug hole.

**To drain the oil,** it is best to have the oil in a warm state to drain easier. Use 80W 90 EP Gear Oil.

- Place a suitable oil receptacle under the gear box
- Carefully remove the fill plug, then the drain plug.
- Allow the oil to drain completely, replace the drain plug.

**To add oil,**

- Remove the fill plug and the level check plug
- Add oil until it starts to come out of the level check hole.
- Reinstall the level check and fill plugs.

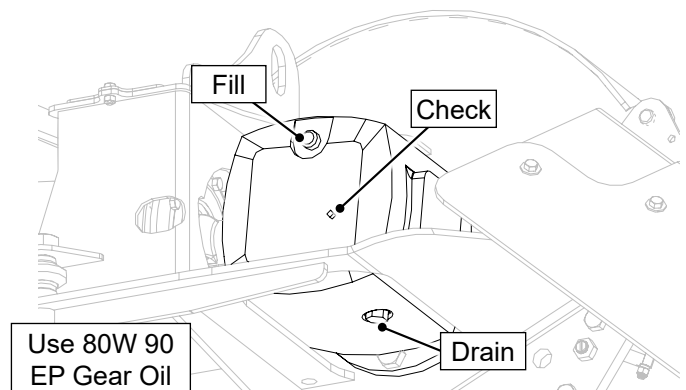

## LUBRICATION

### GREASE:

Inspect bearings and components before each use. Unusual play or noise could be an indication of worn parts. Parts replacement should be performed by qualified personnel.

To prevent premature wear the grease zerks on the stump grinder bearings should be greased every 20 hrs or daily with heavy use.

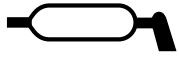

This symbol indicates a grease zerk location shown in the illustrations below.

- Lubricate with an good Lithium EP2 grease or equivalent.
- Use a hand-held grease gun for all greasing, one shot of grease is usually adequate. A full bearing with slight leakage through the seal is the best protection against contaminant entry.
- Wipe grease zerk with a clean cloth before greasing, to avoid injecting dirt and grit.
- Replace any broken zerk fittings immediately.
- If grease zerk will not take grease, remove and clean thoroughly. Also clean lubricant passageway. Replace fittings if necessary.

### LUBRICATE:

Inspect the grinder components before each use. Unusual play or noise could be an indication of worn parts. Parts replacement should be performed by qualified personnel.

To ensure freedom of movement and prevent corrosion the stump grinders components should be lubricated every 20 hrs or more often with heavy use.



This symbol indicates a lubrication point shown in the illustrations below.

- Use a light oil or lubricating spray.



### WARNING Puncture Hazard

Rotor teeth have sharp edges, use caution when working around the rotor, serious injury could result .



### CAUTION Operational Hazard

Personal Protection Equipment (PPE) is required when operating or maintaining this machine.

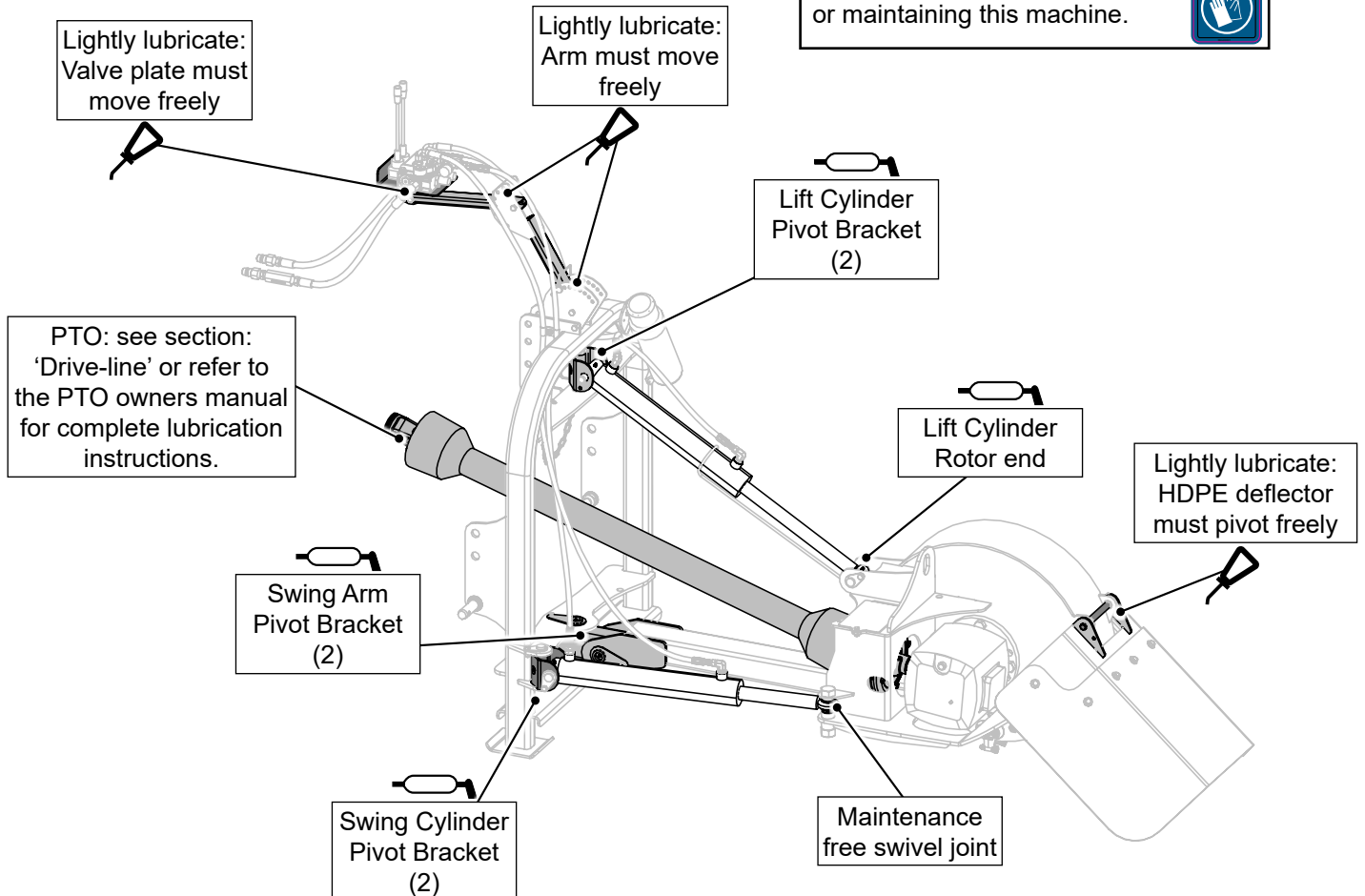

## CUTTING WHEEL

The 25" rotor is equipped with 18 replaceable WearSharp® carbide cutting teeth, mounted in alloy steel tooth pockets. Periodic inspection of the cutting teeth and pockets is recommended to keep the stump grinder performing at its best. Due to the high wear nature of these parts, and the vibration they are subjected to we recommend you inspect your teeth after each use and check all pocket fasteners weekly at a minimum.

For stability we recommended that the stump grinder is attached to the tractor when replacing rotor components.

- Park tractor on a level surface.
- Engage tractor park brake.
- Disengage PTO.
- Shut off engine and remove key.
- Support grinder frame with safety stands to prevent accidental lowering.

Tooth replacement is relatively straight forward and can be done in the field. We recommend that pocket holders be replaced in shop, as they may require some extra effort to remove and ensure they are secure.

New cutting teeth, lock-nuts, spacers and pockets are available from your dealer or call Reist Industries order desk.

### INSPECT CUTTING TEETH

The rotor is equipped with 18 teeth featuring three cutting edges on each tooth. The teeth can be indexed (rotated) twice from their original position allowing for extended tooth life. Due to the wear and shock these parts are subjected to, when replacing teeth we recommend replacing lock-nuts and spacers at the same time.

A good indication it is time to rotate them:

- If you are noticing decreased cutting performance and or rotation speed is noticeably reduced.
- Visibly noting the relief angle on the tooth approaches approximately 50% of the carbide thickness (decreased diameter).
- In extreme cases when teeth are chipped, broken or missing, replacement is required.

### INDEXING CUTTING TEETH

Tools needed: ½" Wrench, wire brush.

- Use a wire brush to clean around the pockets and hardware.
- Using the wrench loosen the locknut that secures the tooth into the pocket (no need to remove the nut completely).
- Tap the tooth out so that the tooth is free and clears the shoulder on the pocket and can be rotated.
- Rotate the tooth a third of a turn.
- Reposition the tooth in its seat. The teeth are designed to rotate in thirds and should fit snugly back into the pocket.
- Re-tighten the locknut to proper torque specifications:  
**20 ft.lbs. (27 Nm)**

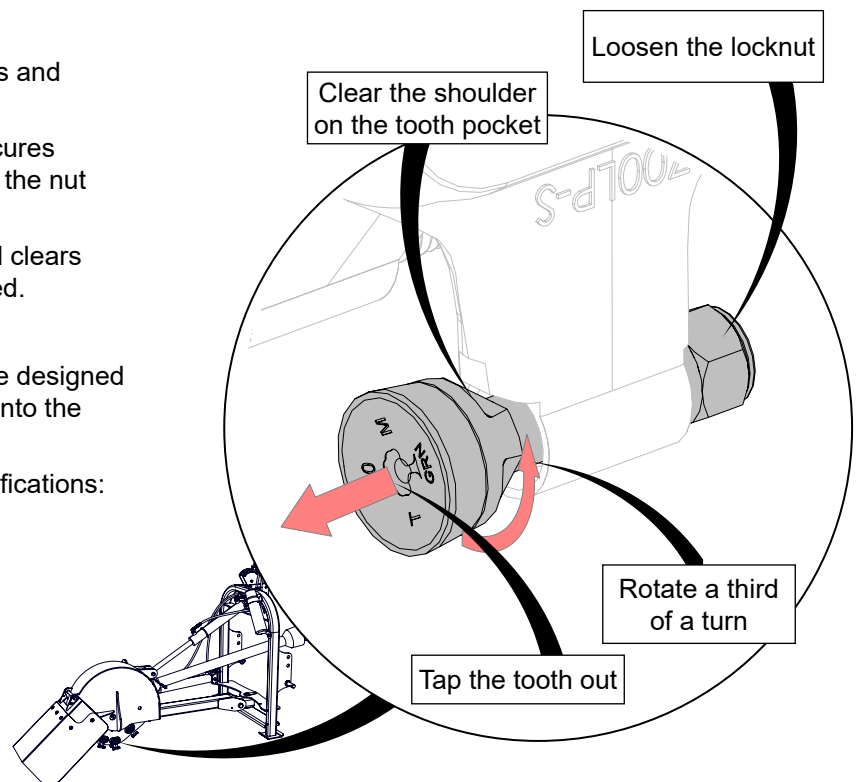

#### **WARNING** **Operational Hazard**

Replacement parts must be properly torqued, under or over torque can cause premature wear or damage leading to personal injury.

## REPLACING CUTTING TEETH

To replace the tooth, follow the indexing instructions and simply remove the locknut and replace the worn tooth with a new one.

- Using a wire brush, clean around the pockets and hardware to make removal easier.
- Using the wrench remove the locknut and spacer then discard.
- Tap the tooth so that the tooth is free from it's seat, remove and discard.
- Position the tooth in it's seat, it should fit snugly into the pocket.
- Assemble the spacer and hand tighten the locknut.
- Tighten the locknut to proper torque specifications: **20 ft.lbs. (27 Nm)**

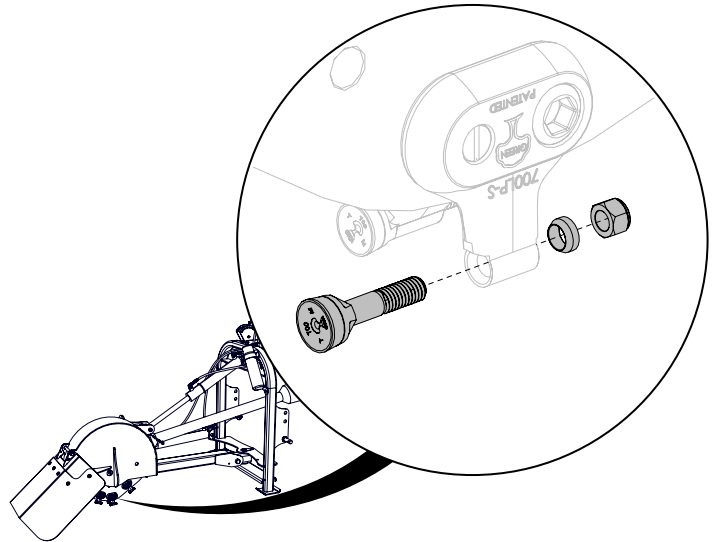

## REPLACING TOOTH POCKETS

If the pocket is damaged or broken it will have to be replaced. Due to the wear and shock these parts are subjected to, when replacing pockets we recommend replacing both bolts and nuts at the same time.

There are three types of pockets mounted on the rotor, determine which pocket you require:

- Angled
- Straight
- Reverse Angled

Tools needed:

- Wire brush
- $\frac{15}{16}$ " Wrench
- $\frac{1}{2}$ " Wrench
- $\frac{1}{2}$ " 6pt Allen Wrench
- Anti Seize Compound

To replace a pocket:

- Using a wire brush, clean both sides of the rotor around the pockets and hardware to make removal easier.
- Make note of the orientation and type of the pocket to be removed.
- Using the  $\frac{1}{2}$ " allen and  $\frac{15}{16}$ " wrench to remove the bolts from each side of the pocket. (allen wrench only for double pockets)
- Discard the old bolts and tooth pocket.
- Using a wire brush, clean both sides of the wheel where it will come in contact with the pockets and hardware. Be sure to remove all dirt and debris so the pocket is seated tightly against the wheel.
- Fit the new matching pocket on the rotor in the same orientation and side as the old one.
- Using a dab of anti seize on the new bolt threads, install the bolts on each side of the pocket.
- Tighten the bolts to torque specs: **180 ft.lbs - 244 Nm .** (240 ft.lbs. - 325 Nm, with out anti-seize).
- Complete the installation by following the steps under 'Replacing Cutting Teeth' to install the cutting teeth.

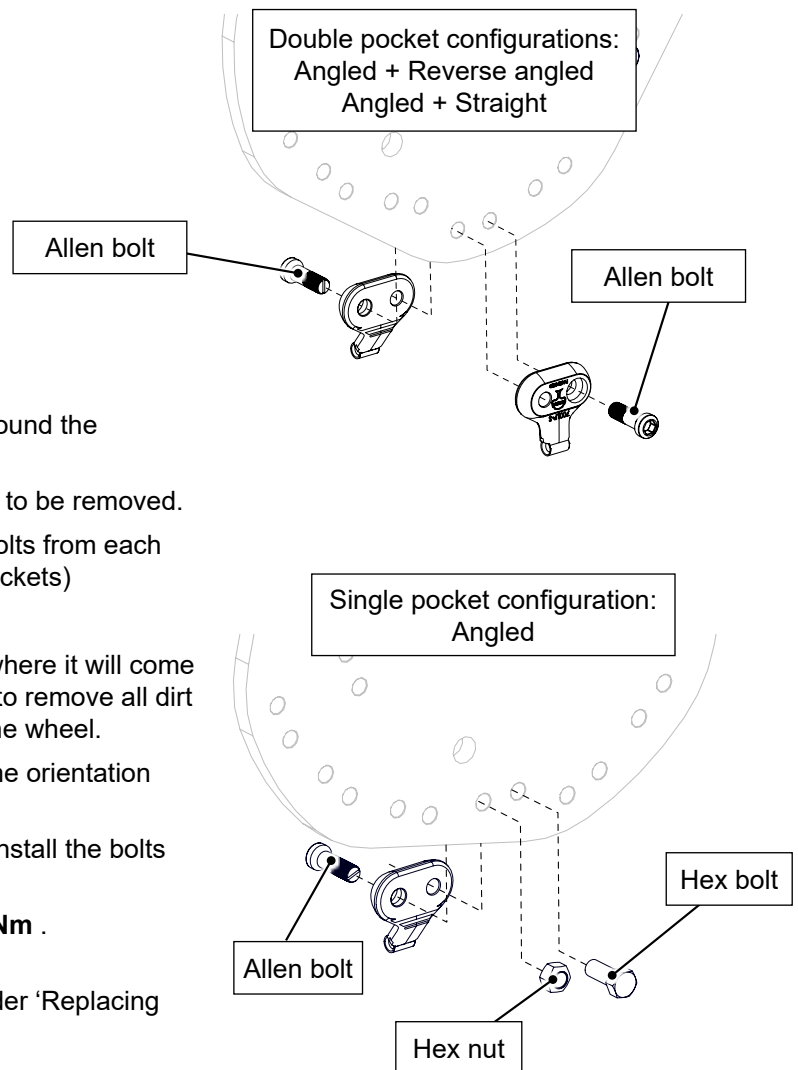

## DRIVE-LINE

### PTO DRIVE-LINE CLUTCH

The slip clutch must be adjusted before first use or after a storage period. The clutch can become locked up over time or due to dirt, corrosion or condensation even if the implement is stored indoors.

Disengage tractor PTO, shut off engine and remove key. Have the stump grinder mounted and the drive-line not installed, and follow the steps below before using your stump grinder to ensure the PTO drive-line clutch plates are set properly.

 This procedure should be performed periodically as the clutch plates can stick together, particularly after periods of inactivity. Stuck plates prevent the clutch from slipping during operation as designed, resulting in high loads and possible damage to the steel shaft or tractor drive components.

- At the clutch end, using a marker, scribe a line across the exposed edges of the hub clutch plate and friction discs.
- Loosen each compression nut exactly two revolutions to free up the clutch friction discs.
- Install the drive-line.
- Start tractor and run the drive-line at a low idle to slip the friction discs. This will remove any the dirt, corrosion from clutch plate faces.
- Disengage tractor PTO. Shut off engine and remove key.
- Inspect the clutch and ensure that the scribed markings on the disc and plates have changed position. If any two marks are still aligned, that is an indication that these discs have not slipped. Repeat the two previous steps.
- If any markings have not moved, disassembly may be required to free up the disks.
- After ensuring all discs are free, tighten the compression nuts uniformly in a star pattern, exactly two revolutions each to reset the clutch to original pressure. (see spring height diagram in maintenance for reference)
- The clutch should be checked during the first hour of use and periodically each week thereafter.
- Be aware of unusual clutch plate slippage, burning odor, or visible smoking, further adjustment may be required.

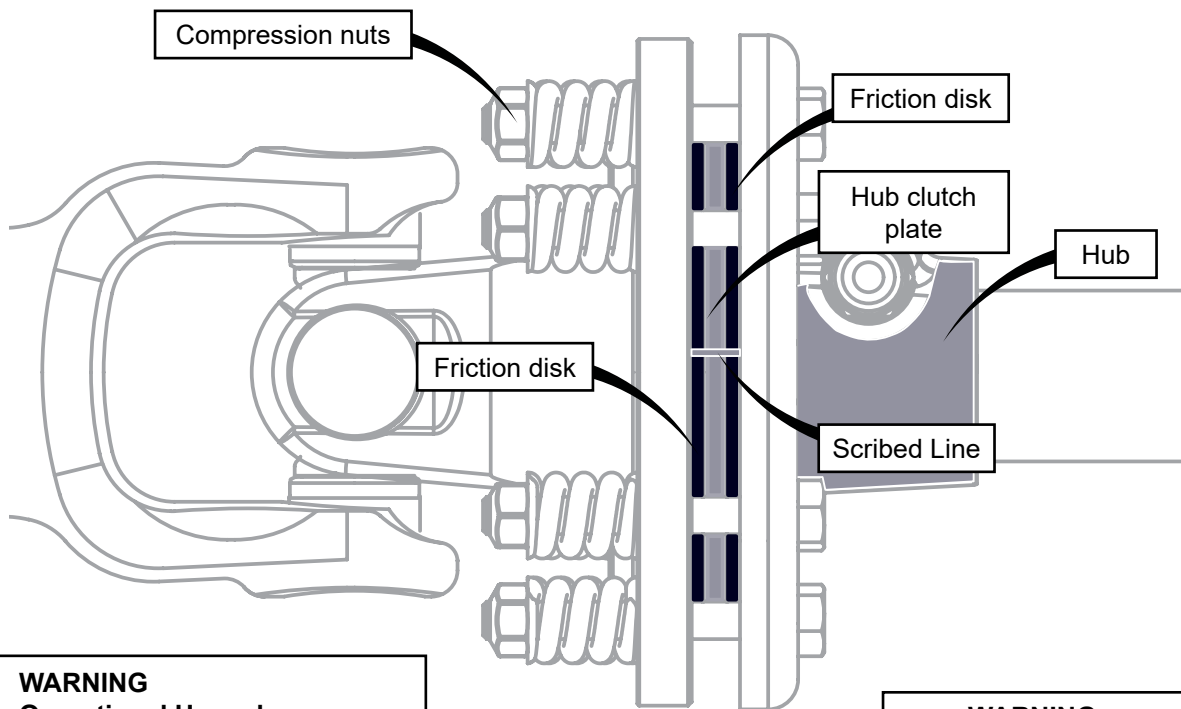

#### WARNING

##### Operational Hazard

The clutch should be checked periodically each week. Excessive clutch plate slippage, burning odour, or visible smoking should not be observed during use.



#### WARNING

##### Operational Hazard

To protect the PTO drive-line from damage or contamination, always use the PTO drive-line support when the unit is not in use.



## PTO DRIVE-LINE CLUTCH SPRING HEIGHT

After any clutch adjustment check that the clutch springs are adjusted to the correct height

When delivered from the factory, friction clutches are set to their rated torque settings. This is achieved by tensioning the clutch springs to their correct compressed length. Compressing the springs too much will cause damage to the clutch by not allowing it to slip, not enough compression will cause clutch burnout.

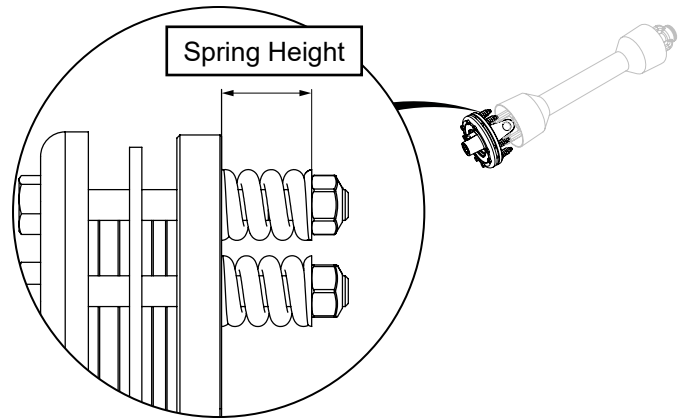

## LUBRICATION

Lubricate with a good EP grease or equivalent. (Epic EP 102) Refer to the lubrication illustration below for location and timing.

- Use a hand-held grease gun for all greasing, one shot of grease is adequate.
- Wipe grease zerk with a clean cloth before greasing, to avoid injecting dirt and grit.
- Replace any broken zerk fittings immediately.
- If grease zerk will not take grease, remove and clean thoroughly. Also clean lubricant passageway. Replace fittings if necessary.
- Separate the drive-line to lubricate the tubes
- Use a light oil or lubricating spray for yoke lock components

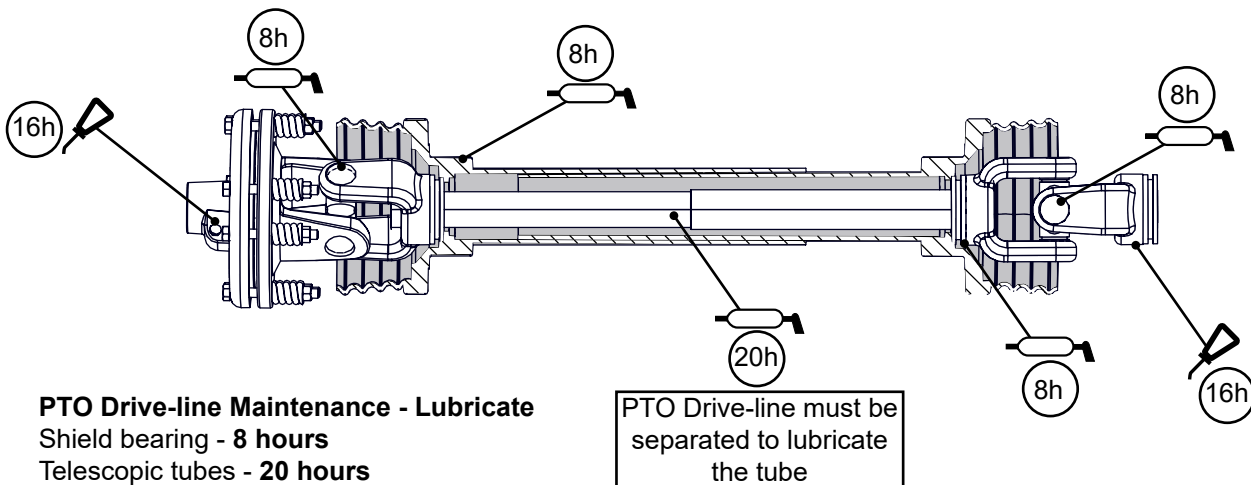

### PTO Drive-line Maintenance - Lubricate

Shield bearing - **8 hours**  
 Telescopic tubes - **20 hours**  
 Lock pins & slide lock - **16 hours**  
 U-joint - **8 hours**



#### CAUTION Operational Hazard

When repairing or maintaining the unit ensure power unit is off and the key is removed and pocketed.



#### CAUTION Operational Hazard

Personal Protection Equipment (PPE) is required while assembling or maintaining this machine.



#### CAUTION Heavy or bulky parts

Prevent potential strain injury, use approved lifting equipment or ask for help when lifting or moving heavy, bulky parts.



#### WARNING Operational Hazard

To protect the PTO drive-line from damage or contamination, always use the PTO drive-line support when the unit is not in use

## BOLT TORQUE TABLE

These tables are offered as the suggested maximum torque values for dry (not lubricated) threaded products and are only a general guide.

Check tightness of bolts periodically, replace hardware with the same strength bolt.

Torque specification for bolts are identified by their head markings as shown.

### METRIC TORQUE SPECIFICATIONS

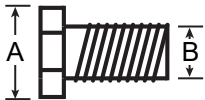

Wrench Size: "A"	Thread Size: "B" Fine	Class 8.8		Class 10.9		Thread Size: "B" Coarse	Class 8.8		Class 10.9	
		N-m	lbs-ft	N-m	lbs-ft		N-m	lbs-ft	N-m	lbs-ft
10 mm	6 x 0.75	---	---	---	---	6 x 1.0	11.3	8.3	16.5	12.2
13 mm	8 x 1.0	27	20	38	28	8 x 1.25	27.3	20.1	40.1	29.6
16 mm	10 x 1.25	52	38	73	54	10 x 1.5	54	40	49	36
18 mm	12 x 1.25	95	70	135	100	12.1.75	93	69	137	101
21 mm	14 x 1.5	150	111	210	155	14 x 2.0	148	109	218	161
24 mm	16 x 1.5	225	166	315	232	16 x 2.0	230	170	338	249
27 mm	18 x 1.5	325	240	460	339	18 x 2.5	329	243	469	346
30 mm	20 x 1.5	460	339	640	472	20 x 2.5	464	342	661	487
34 mm	22 x 1.5	610	450	860	634	22 x 2.5	634	468	904	667
36 mm	24 x 2.0	780	575	1100	811	24 x 3.0	798	588	1136	838
41 mm	27 x 3.0	---	---	---	---	27 x 3.0	1176	867	1674	1234
46 mm	30 x 2.0	---	---	---	---	30 x 3.0	1597	1178	2274	1677

### SAE TORQUE SPECIFICATIONS

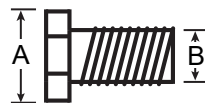

Wrench Size: "A"	Thread Size: "B" Fine	SAE 2		SAE 5		SAE 8		Thread Size: "B" Coarse	SAE 2		SAE 5		SAE 8	
		lbs-ft	N-m	lbs-ft	N-m	lbs-ft	N-m		lbs-ft	N-m	lbs-ft	N-m	lbs-ft	N-m
7/16"	1/4-28	6	8.1	10	13.6	14	19.0	1/4-20	5	6.8	8	10.8	12	16.3
1/2"	5/16-24	13	17.6	19	25.7	27	36.6	5/16-18	11	14.9	17	23.0	25	33.9
9/16"	3/8-24	23	31.2	35	47.4	49	66.4	3/8-16	20	27.1	31	42.0	44	59.6
5/8"	7/16-20	36	48.8	55	74.5	75	101.6	7/16-14	32	43.4	49	66.4	70	94.9
3/4"	1/2-20	55	74.5	85	115.2	120	162.6	1/2-13	49	66.4	75	101.6	107	145.0
13/16"	9/16-18	79	107.0	122	165.3	172	233.1	9/16-12	70	94.9	109	147.7	154	208.7
15/16"	5/8-18	110	149.1	170	230.4	240	325.2	5/8-11	97	131.4	150	203.3	212	287.3
1-1/8"	3/4-16	192	260.2	297	402.4	420	569.1	3/4-10	173	234.4	266	360.4	376	509.5
1-5/16"	7/8-14	184	249.3	474	642.3	668	905.1	7/8-9	166	224.9	429	581.3	606	821.1
1-1/2"	1.0-12	274	371.3	705	955.3	995	1348.2	1.0-8	250	338.8	644	872.6	909	1231.7

# TROUBLE SHOOTING

On the following pages, we have listed many of the causes and solutions to issues that you may encounter.

If you encounter a issue that is difficult to solve, even after having read through this trouble shooting section, please call your local distributor or dealer. Before you call, please have this Operator's Manual and serial number ready

Problem	Cause	Solution
The cutting disk stops during cutting.	Cutting too deep.	Decrease cutting depth
	Cutting too fast	Move slower across the stump
	Rotor jammed.	Remove jam material from rotor
Gearbox stub shaft broken.	Driveshaft angle is too severe	Stay within PTO ANGLE specs, replace stub
	Locked up slip clutch	Perform PTO clutch maintenance, replace stub
The grinder rotor does not cut fast enough, lacking cutting power	Teeth are worn, damaged, or broken	Rotate or replace any worn, damaged or broken teeth
	Cutting tooth pocket damaged, or broken	Replace cutting tooth pocket
	Slip clutch is slipping.	Perform PTO clutch maintenance, check adjustment of clutch spring. Caution: Clutch may be very hot!
	Cutting too deep.	Decrease cutting depth
	Cutting too fast	Move slower across the stump
	Tractor not set to full throttle	Set tractor to full throttle: max 540 RPM
	Tractor too small.	Use tractor within size specifications
	Tractor too powerful	Use tractor within size specifications. Slippage on the clutch occurs if there is more power than the unit is rated for. Caution: Clutch may be very hot! Idle down: this will decrease the output power of the engine.
Tractor is not able to lift 3-point.	Tractor is too small.	Move link pins to the top position on the stump grinder to add leverage.
		Use tractor within size specifications

On the following page, we have listed many of the causes and solutions to issues that you may encounter.

If you encounter a issue that is difficult to solve, even after having read through this trouble shooting section, please call your local distributor or dealer. Before you call, please have this Operator's Manual and serial number ready

<b>Problem</b>	<b>Cause</b>	<b>Solution</b>
Rotor cannot be lifted high enough.	Stump too tall.	Cut stump shorter.
Rotor cannot be lowered far enough.	Top link not correct length.	Lengthen top link on 3-point hitch, stay within PTO angle specifications.
Stump grinder vibrating, bouncing	Rotor turning wrong direction	Ensure rotor is turning clockwise while standing behind the tractor.
	Too much pressure on grinder	Raise the grinder up slightly to allow the head to float.
	Dense material, cutting too fast, worn teeth	Move slower across the stump, perform maintenance on cutting teeth
	Starting cut on the wrong side or middle of the stump	Always start on the right side and move forward from the front to the back of the stump
Smoke or burning smell	Slip clutch is slipping.	Perform PTO clutch maintenance, check adjustment of clutch spring. Caution: Clutch may be very hot!
		Use tractor within size specifications Slippage on the clutch occurs if there is more power than the unit is rated for. Caution: Clutch may be very hot!
	Cutting too fast, worn teeth	Move slower across the stump, perform maintenance on cutting teeth
Broken or damaged cutting teeth or tooth pockets	Impact with foreign objects	Check for imbedded objects in the stump or rocks or buried metal below the soil

# Notes

## ACCESSORIES

For accessories or replacement parts, call your dealer for pricing and availability or go to [reistindustries.com](http://reistindustries.com).

### # STGV R25PS VALVE KIT

Excellent add on for model R25PS, useful for tractors equipped with one remote.

- Mounted on ergonomic adjustable arm.
- Includes all hoses and hardware required.

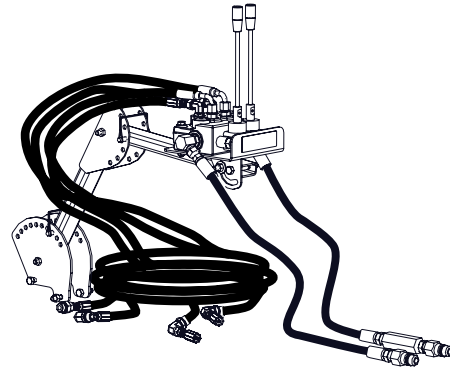

### # DS510 DEBRIS SCREEN

Used in areas where debris from the stump grinder needs to be contained, includes 4 posts with integrated ground spikes.

- 10' wide by 5' high
- 9 oz 1000D woven PVC coated polyester

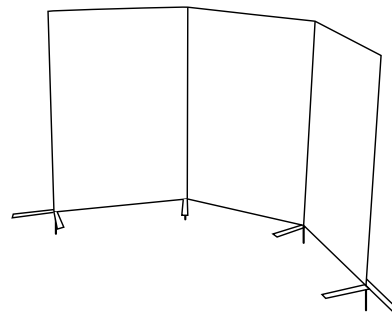



## WARRANTY

### Warranty for R25PSS & R25PSV Stump Grinder 3PH PTO Driven Hydraulic Swing

All new Reist machinery is warranted to be free from defects in material or workmanship, which may cause failure under normal usage and service when used for the purpose intended, for a period of 12 months. This warranty applies only to a new Reist product, there being no warranty of any nature in respect to new products that have been modified or altered, repaired, neglected, or used in any way, which, in the opinion of Reist adversely affects its performance.

In the event of failure of a part or parts, and upon inspection, Reist is satisfied that failure is due to defective material or workmanship within 12 calendar months, from the date of delivery to an end user, such defective part or parts will be repaired or replaced by Reist at his business location. It is the responsibility of the buyer, at his expense, to transport the machine or equipment to the manufacturer service shop or, to an authorized service depot or, alternatively, to reimburse Reist for any travel or transportation expense involved in fulfilling this warranty.

When requested by Reist, part or parts shall be returned for inspection, transportation prepaid, to a place designated by Reist. IN NO EVENT SHALL THE BUYER BE ENTITLED TO RECOVER FOR INCIDENTAL OR CONSEQUENTIAL DAMAGES, INCLUDING, BUT NOT LIMITED TO, LOSS OF PRODUCT, INCONVENIENCE, RENTAL OR REPLACEMENT EQUIPMENT, LOSS OF PROFIT, OR OTHER COMMERCIAL LOSS.

This warranty becomes void and null if the equipment is modified, breaks down as the result of an accident, is not operated according to manufacturers recommendations, damaged by negligence or if maintenance has not been carried out as specified.

THIS WARRANTY IS NOT TRANSFERABLE



100 Union Street • Elmira, Ontario,  
Canada • N3B 2Z2

[www.reistindustries.com](http://www.reistindustries.com)